

Specifications for dual maintenance full color LED display

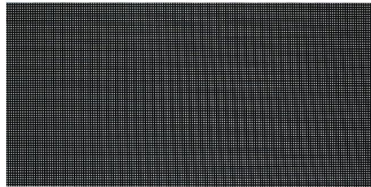

Module

Cabinet



- ◆ Fully enclosed module, higher protection grade with higher stability;
- ◆ 640 * 320mm fully enclosed module, allowing users to quickly assemble signs of different sizes with more flexibility;
- ◆ Thin and light weight module; Weight $\leq 25\text{kg/m}^2$; Small size and light weight, saving large storage and transportation costs;
- ◆ Saving structural costs: Module with fixed bracket=large screen, eliminating bulky cabinet and saving framework costs.
- ◆ Fast installation: Fast lock without screws, and connectors with fast cabling, high efficiency;
- ◆ The two in one power and signal cable can be quickly connected, convenient to connect with beautiful cabling;
- ◆ Wall mounted: Module, power supply, and system front maintenance design can meet various wall mounting conditions;
- ◆ Low noise: No fan design, ensuring a noise level of less than 25 decibels;
- ◆ High protection grade: Front and rear IP65, durable in stormy weather;
- ◆ Dedicated to providing comprehensive solutions for high-end displays, such as outdoor commercial squares, road advertisements, doorstep advertisements, and window displays, etc.

Technical Parameters:

	Item	Specification Parameter
Module Parameter	Pixel Pitch、Resolution rate、size	4mm、160*80 Dots、640*320mm
	Pixel color、 Pixel LED	1R1G1B、 SMD1515
	Working voltage、 Module Power	DC4.6V、 33W
	Driving IC、 Driving way	ICND2153、 1/10
	HUB	QP640X320-HUB23 (AXS)-V1.3
Cabinet Parameter	Material、 Cabinet Weight(kg/Cabinet)	Alloy cabinet、 1.6kg+4.5KG /pcs
	Resolution rate、 size、 Module quantity	160*80 Dots、 640*320*75mm、 1*1
	Density	62500 Dots/m ²
	White balance 、 Color temperature	5500 CD/m ² 、 6500K-8000K
	view angel、 Non-Flatness、 Module interval	H/V: 110° /110° 、 <0.5mm、 <0.5mm
	Maximal power/m ² 、 Average power/m ²	700W/m ² 、 300W/m ²
	Frame frequency、 Refresh frequency、 Gray grade	60Hz、 3840Hz、 13bit
	Control system、 System supports	CHIPSHOW, Windows XP, WIN 7
	Working temperature、 Protection grade	- 20~50℃、 Front/Back: IP65/IP65
*Reference information, different configurations, different parameters		

Package Parameters:

Gross Weight (kg)	68kg (Estimated data,10pcs /Case)
Outer Package Size	1110*700*500mm (Estimated data,10pcs /Case)
Packing Material	Flight case



Assembly Sketch Map/Power Cable And Signal Cable Connection Sketch Map:

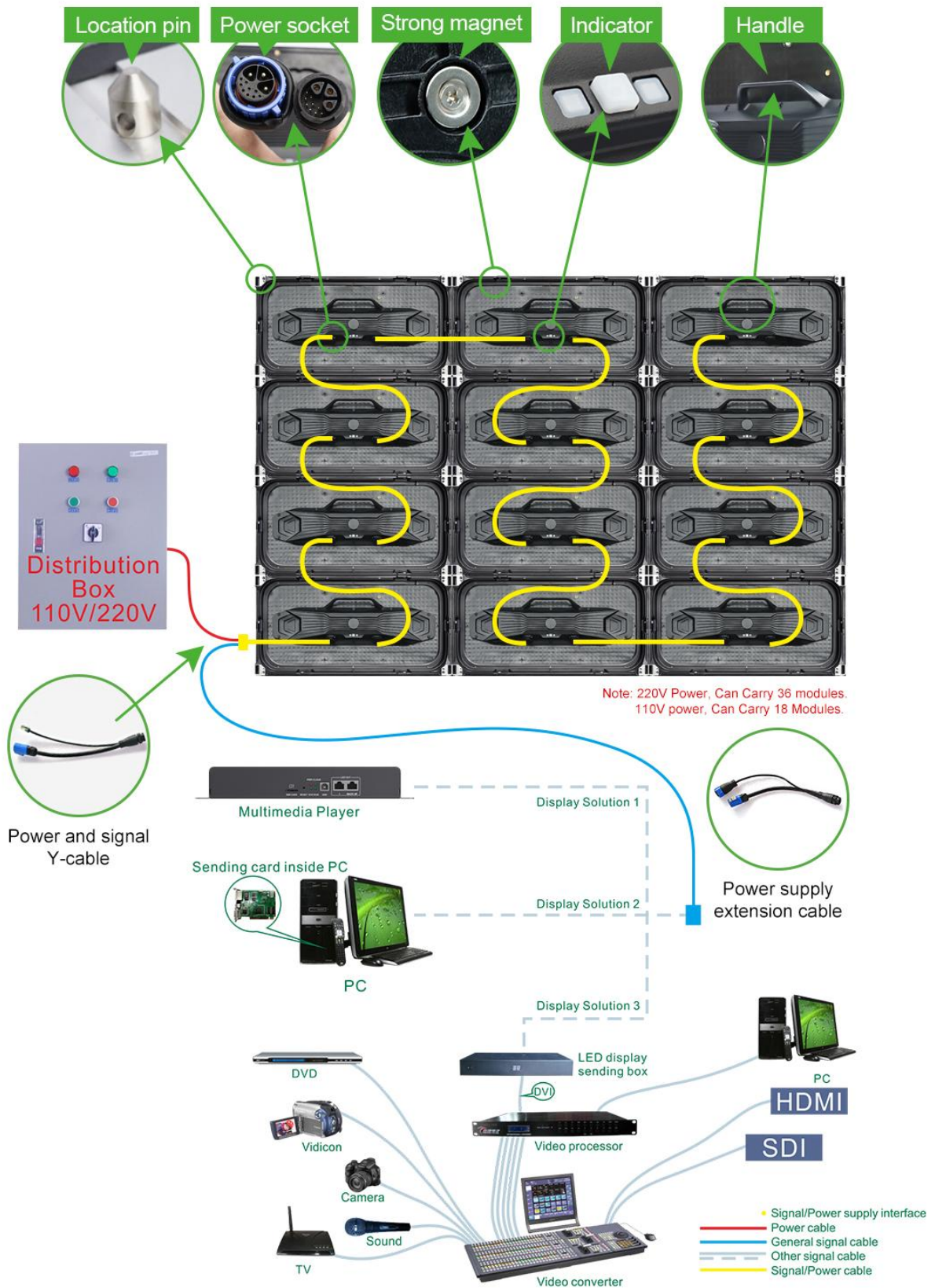

Static Cabinet integration SMALL-SIGNS-ONLY!

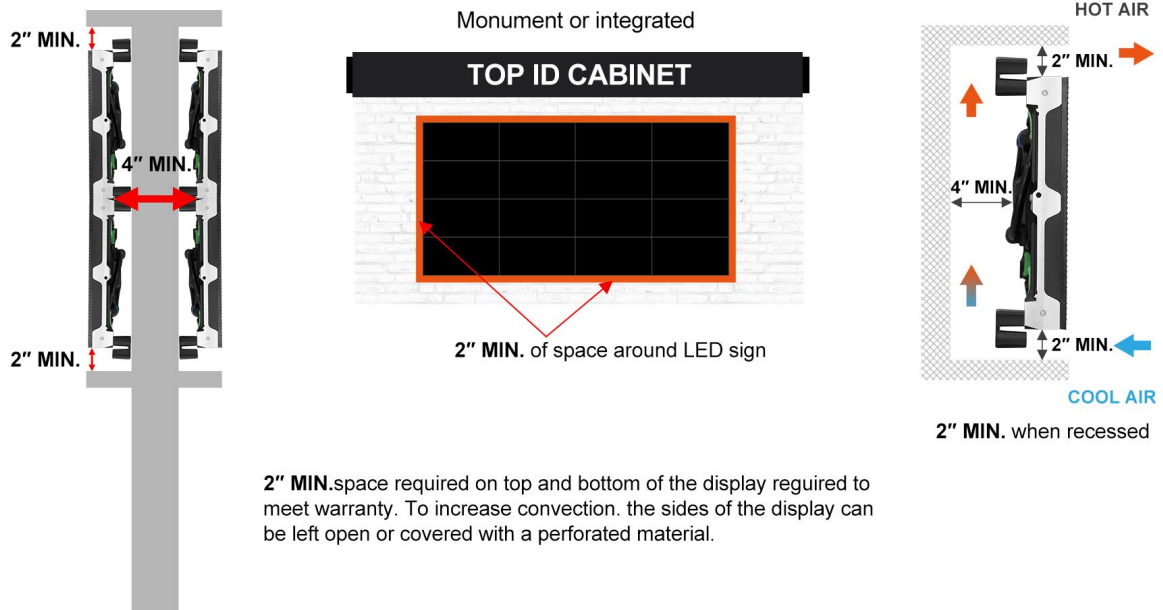

2" MIN. space required on top and bottom for convection
Do not block ventilation with cross brackets/ supports

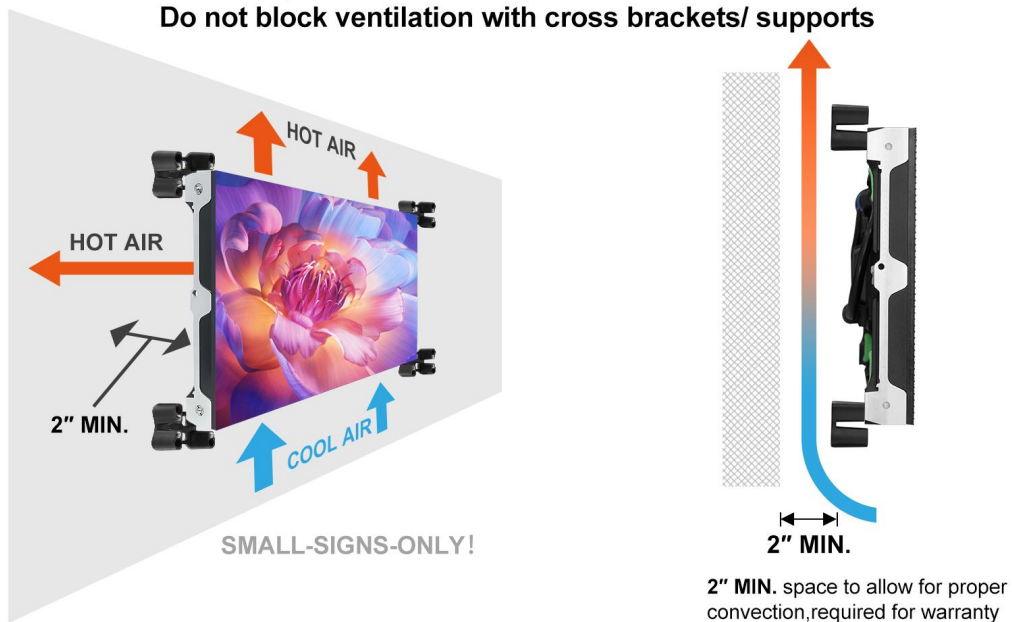

P4 HD Full-Color Smart LED Screen Specification

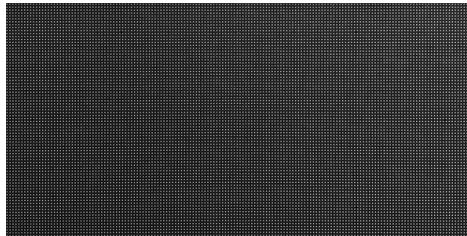

Module



Cabinet

- ◆ Fully enclosed module, higher protection grade with higher stability;
- ◆ 640 * 320mm fully enclosed module, allowing users to quickly assemble signs of different sizes with more flexibility;
- ◆ Thin and light weight module; Weight $\leq 25\text{kg/m}^2$; Small size and light weight, saving large storage and transportation costs;
- ◆ Saving structural costs: Module with fixed bracket=large screen, eliminating bulky cabinet and saving framework costs.
- ◆ 2-in-1 cable for quick connection, easy plug-and-play installation, saving labor time with neat wiring.
- ◆ Wall mounted: Module, power supply, and system front maintenance design can meet various wall mounting conditions;
- ◆ Low noise: No fan design, ensuring a noise level of less than 25 decibels;
- ◆ High protection grade: Front and rear IP66, durable in stormy weather;
- ◆ Dedicated to providing comprehensive solutions for high-end displays, such as outdoor commercial squares, road advertisements, doorstep advertisements, and window displays, etc.

Technical Parameters:

	Item	Specification Parameter
Module Parameter	Pixel Pitch、 Resolution rate、 size	4mm、 160*80 Dots、 640*320mm
	Pixel color、 Pixel LED	1R1G1B、 SMD1415
	Working voltage、 Module Power	DC4.2V、 160W
	Driving IC、 Driving way	ICND2153S、 1/10
	HUB	HUB75
Cabinet Parameter	Material、 Cabinet Weight(kg/Cabinet)	Die-cast aluminum、 Aluminum frame 1.4+3.9kg/PCS
	Resolution rate、 size、 Module quantity	160*80Dots、 640*320*55mm、 1*1
	Density	62500 Dots/m ²
	White balance 、 Color temperature	6000CD/m ² 、 6500-8000K
	view angel、 Non-Flatness、 Module interval	H: 110° ; V: 110° 、 <0.5mm、 <0.5mm
	Maximal power/m ² 、 Average power/m ²	≤700W/m ² 、 ≤210W/m ²
	Frame frequency、 Refresh frequency、 Gray grade	60Hz、 ≤7680Hz、 14bit
	Control system、 System supports	CHIPSHOW、 Windows XP、 WIN 7
	Working temperature、 Protection grade	- 20~50°C、 Front/Back: IP66
*Reference information, different configurations, different parameters		

Package Parameters:

Gross Weight (kg)	68kg (Estimated data,10pcs /Case)
Outer Package Size	1110*700*500mm (Estimated data,10pcs /Case)
Packing Material	Flight case



Assembly Sketch Map/Power Cable And Signal Cable Connection Sketch Map:

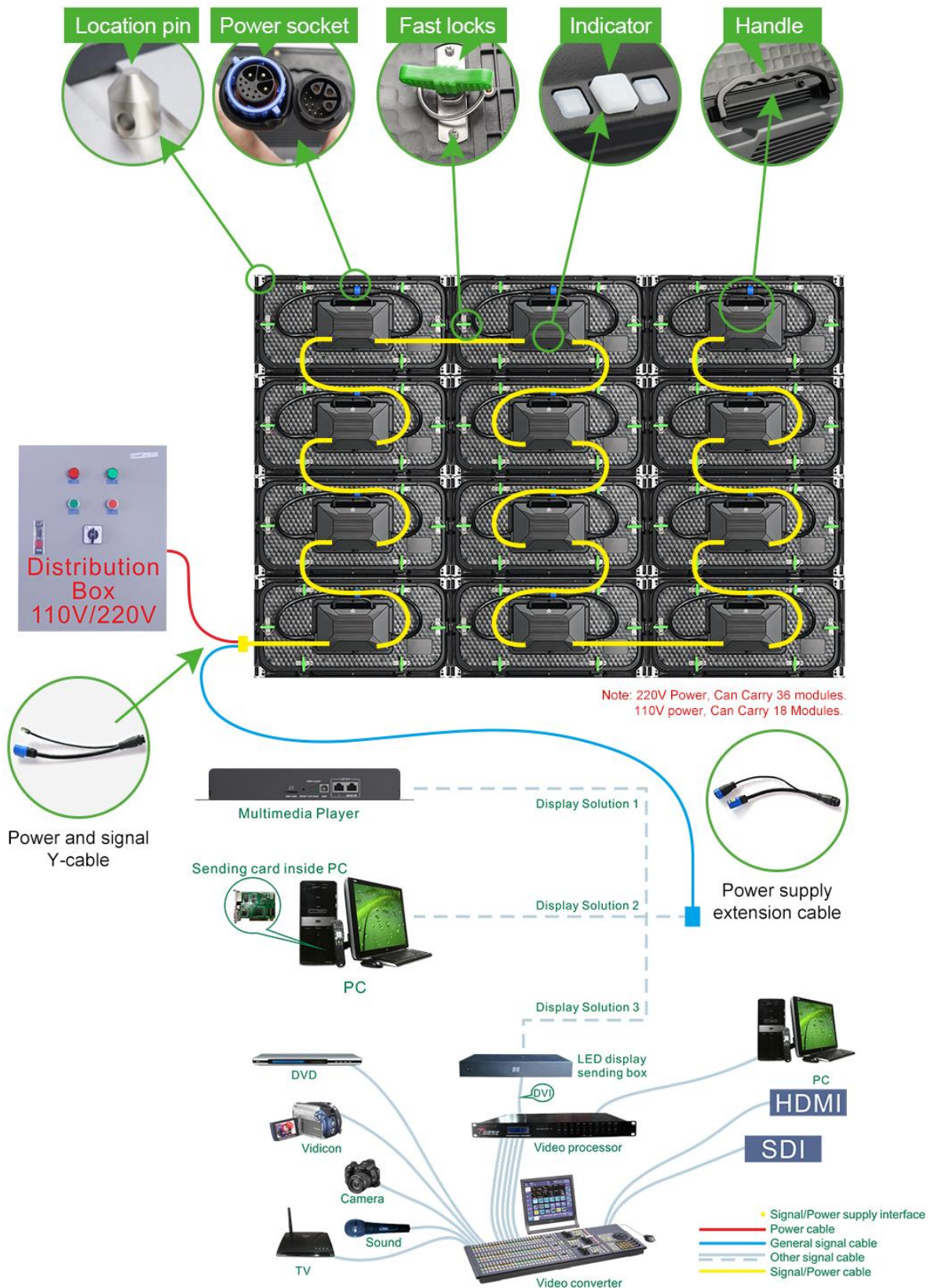

Static Cabinet integration SMALL-SIGNS-ONLY!

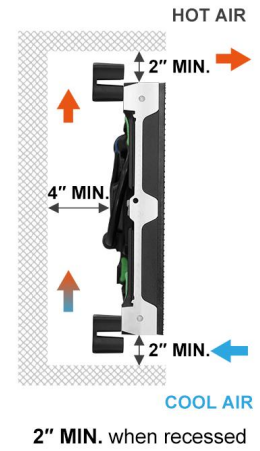
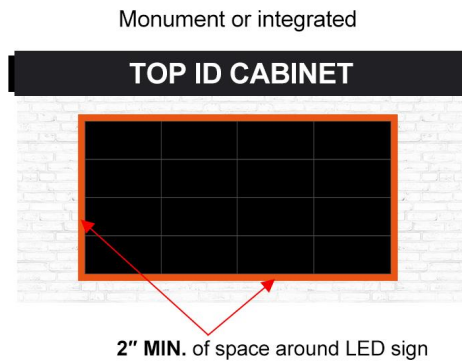
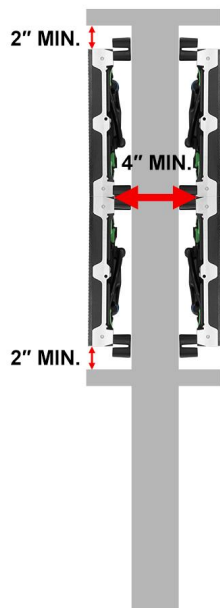

2" MIN. space required on top and bottom of the display required to meet warranty. To increase convection, the sides of the display can be left open or covered with a perforated material.

2" MIN. space required on top and bottom for convection
Do not block ventilation with cross brackets/ supports

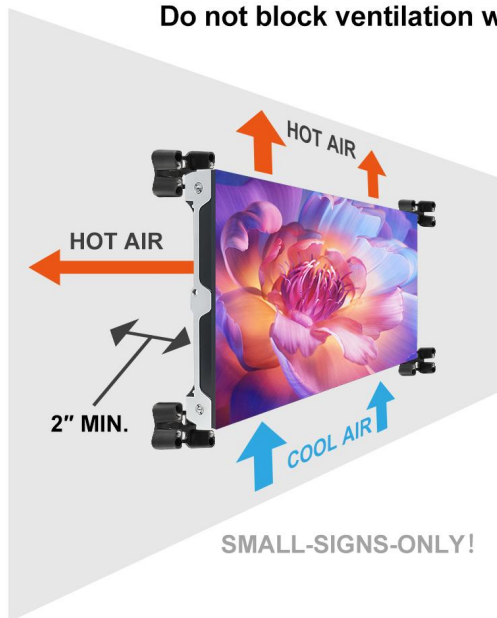

2" MIN. space to allow for proper convection, required for warranty

Specifications for dual maintenance full color LED display

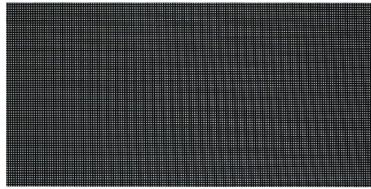

Module

Cabinet



Product characteristics:

1. Integrated design: module and box integration, replacing the traditional box, saving costs.
2. Ultra-thin design: wall-mounted installation, front and rear maintenance is more convenient.
3. Unique design: Unique module design, deep color, high contrast.
4. Good flatness: module size 640mm*320mm, larger size, better flatness.
6. High brightness: brightness $\leq 5500\text{cd/m}^2$, good light distribution curve, good Angle consistency.

Technical Parameters:

	Item	Specification Parameter
Module Parameter	Pixel Pitch、Resolution rate、size	4mm、160*80 Dots、640*320mm
	Pixel color、 Pixel LED	1R1G1B、 SMD1515
	Working voltage、 Module Power	DC4.6V、 33W
	Driving IC、 Driving way	ICND2153、 1/10
	HUB	QP640X320-HUB23 (AXS)-V1.3
Cabinet Parameter	Material、 Cabinet Weight(kg/Cabinet)	Alloy cabinet、 1.6kg+4.5KG /m ²
	Resolution rate、 size、 Module quantity	160*80 Dots、 640*320*75mm、 1*1
	Density	62500 Dots/m ²
	White balance 、 Color temperature	5500 CD/m ² 、 6500K-8000K
	view angel、 Non-Flatness、 Module interval	H/V: 120° /120° 、 <0.5mm、 <0.5mm
	Maximal power/m ² 、 Average power/m ²	700W/m ² 、 300W/m ²
	Frame frequency、 Refresh frequency、 Gray grade	60Hz、 3840Hz、 13bit
	Control system、 System supports	CHIPSHOW, Windows XP, WIN 7
	Working temperature、 Protection grade	- 20~50℃、 Front/Back: IP65/IP65
*Reference information, different configurations, different parameters		

Package Parameters:

Gross Weight (kg)	68kg (Estimated data, 12pcs /Case)
Outer Package Size	1110*700*500mm (Estimated data, 12pcs /Case)
Packing Material	Flight case



Assembly Sketch Map/Power Cable And Signal Cable Connection Sketch Map:

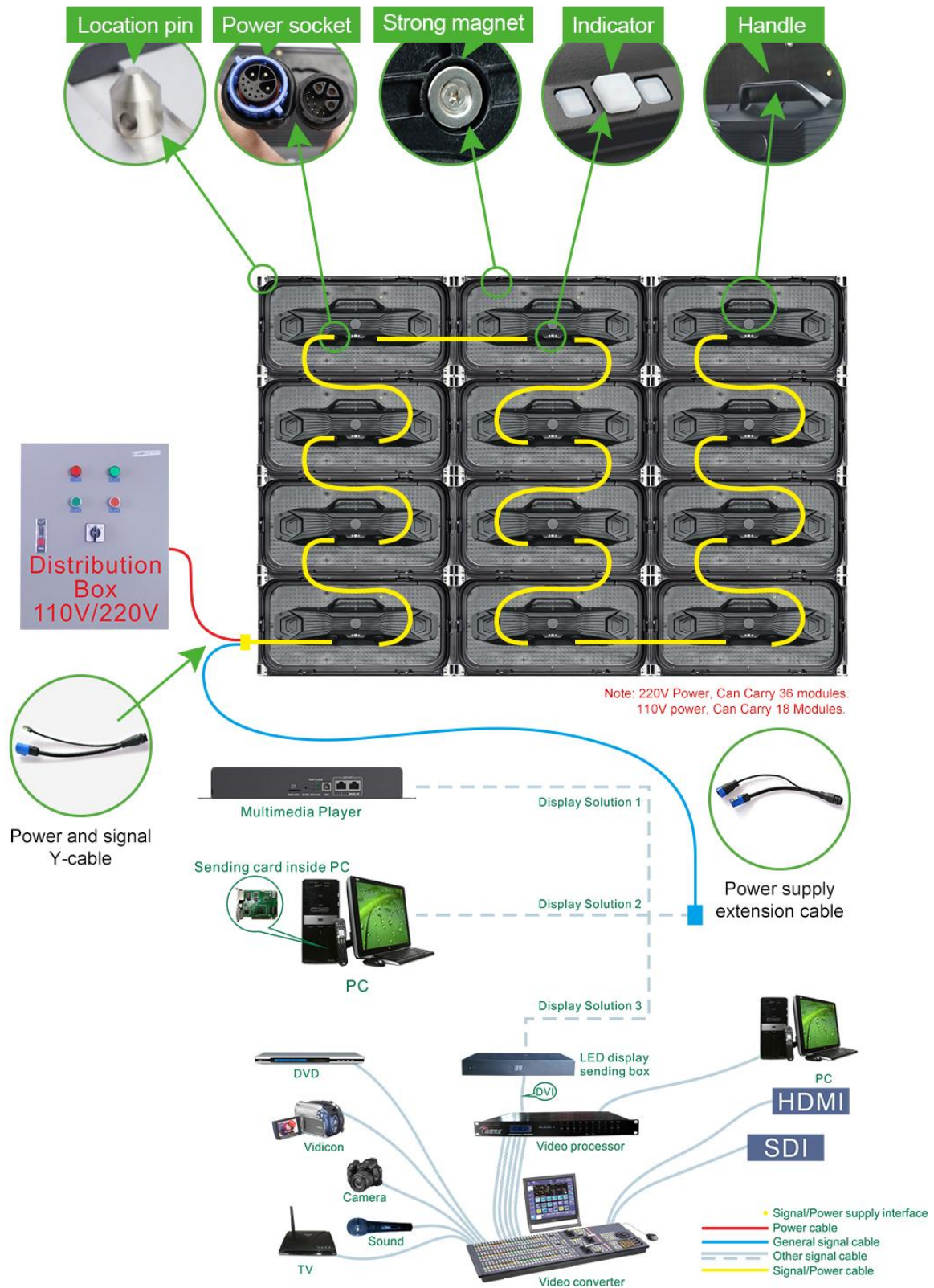

Static Cabinet integration SMALL-SIGNS-ONLY!

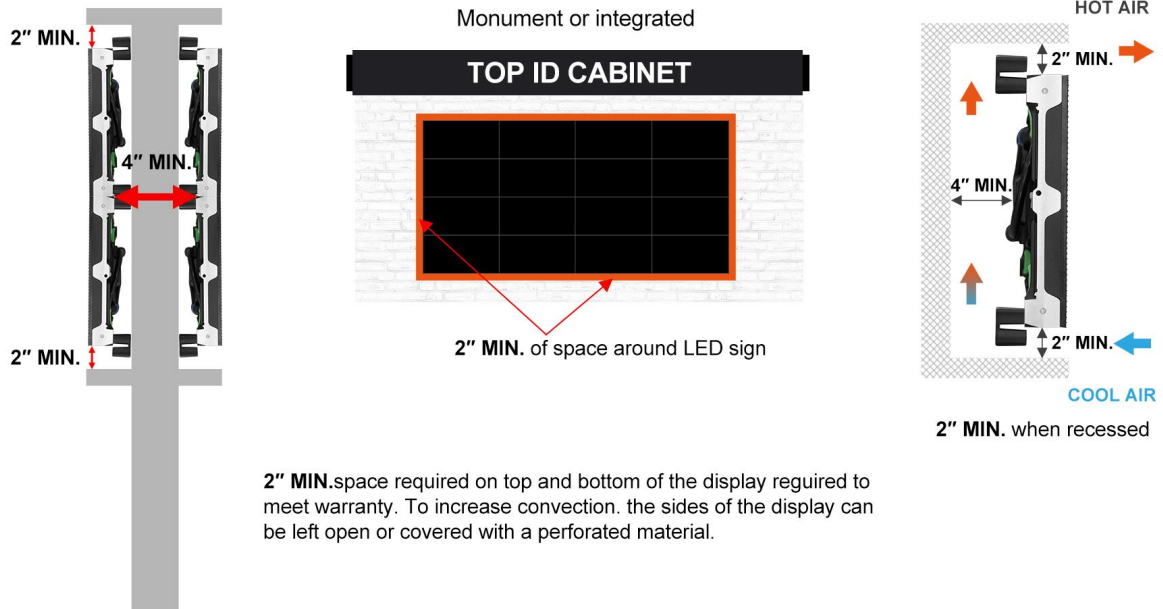

**2" MIN. space required on top and bottom for convection
Do not block ventilation with cross brackets/ supports**

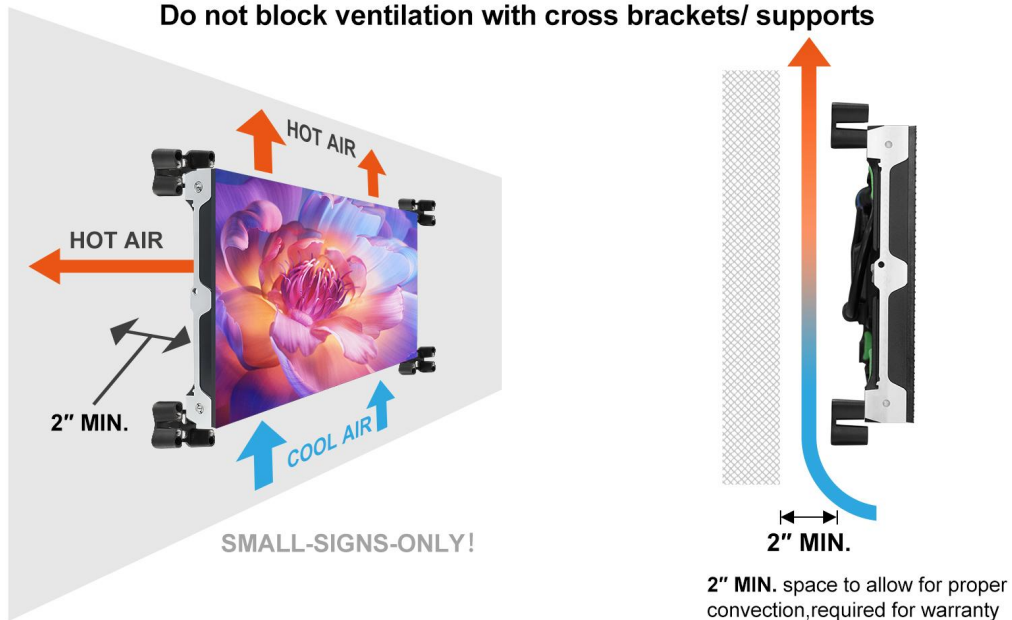

P5.95 Dual Maintain Full-Color LED Display Screen Specification



Module

Cabinet



- ◆ Fully Closed Integrated Module: Built-in heat dissipation plate ensures uniform cooling.
- ◆ 500×500mm Unit: Enables quick assembly of various signage sizes.
- ◆ Lightweight Module: $\leq 29\text{kg/m}^2$, reducing storage and transportation costs.
- ◆ Simplified Structure: Module + fix frame = large screen, saving cabinet and steel structure costs.
- ◆ Quick Installation: Fast locks without screw install; aviation connectors for efficient cabling and labor savings.
- ◆ Tidy Cabling: Integrated signal and power cables for convenient connections and a clean layout.
- ◆ Wall-Mounted: Front maintenance design adapts to various installation occasions.
- ◆ High Protection: IP67 front and rear protection, ensuring normal operation even when submerged, resistant to wind and rain.
- ◆ Tailored for Outdoor: Ideal LED display solution for city squares, storefront signage, and window advertising, etc.

Technical Parameters:

	Item	Specification Parameter
Module Parameter	Pixel Pitch、Resolution rate、size	5.95mm、84*84 Dots、500*500mm
	Pixel color、 Pixel LED	1R1G1B、 SMD1921
	Working voltage、 Module Power	DC4.6V、 200W
	Driving IC、 Driving way	ICND2153、 1/3
	HUB	C-SmartP5.95-500X500-HUB V1.0
Cabinet Parameter	Material、 Cabinet Weight(kg/Cabinet)	Aluminum Frame: 1.95kg + Module: 5.3KG/PCS, Total Weight: 7.25KG
	Resolution rate、 size、 Module quantity	84*84 Dots、 500*500*57mm、 1*1
	Density	28224 Dots/m ²
	White balance 、 Color temperature	6000 CD/m ² 、 6500K-8000K
	view angel、 Non-Flatness、 Module interval	H/V: 110° /110° 、 <0.5mm、 <0.5mm
	Maximal power/m ² 、 Average power/m ²	≤800W/m ² 、 ≤240W/m ²
	Frame frequency、 Refresh frequency、 Gray	60Hz、 3840Hz、 13bit
	Control system、 System supports	CHIPSHOW, Windows XP, WIN 7
	Working temperature、 Protection grade	- 30~60°C、 Front/Back: IP67/IP67
*Reference information, different configurations, different parameters		

Package Parameters:

Gross Weight (kg)	60kg (Estimated data,6pcs /Case)
Outer Package Size	590*600*740mm (Estimated data,6pcs /Case)
Packing Material	Lid and base box + carton packaging + protective corner + EPE * Packaging for reference only, Please refer to the actual order.



Assembly Sketch Map/Power Cable And Signal Cable Connection Sketch Map:

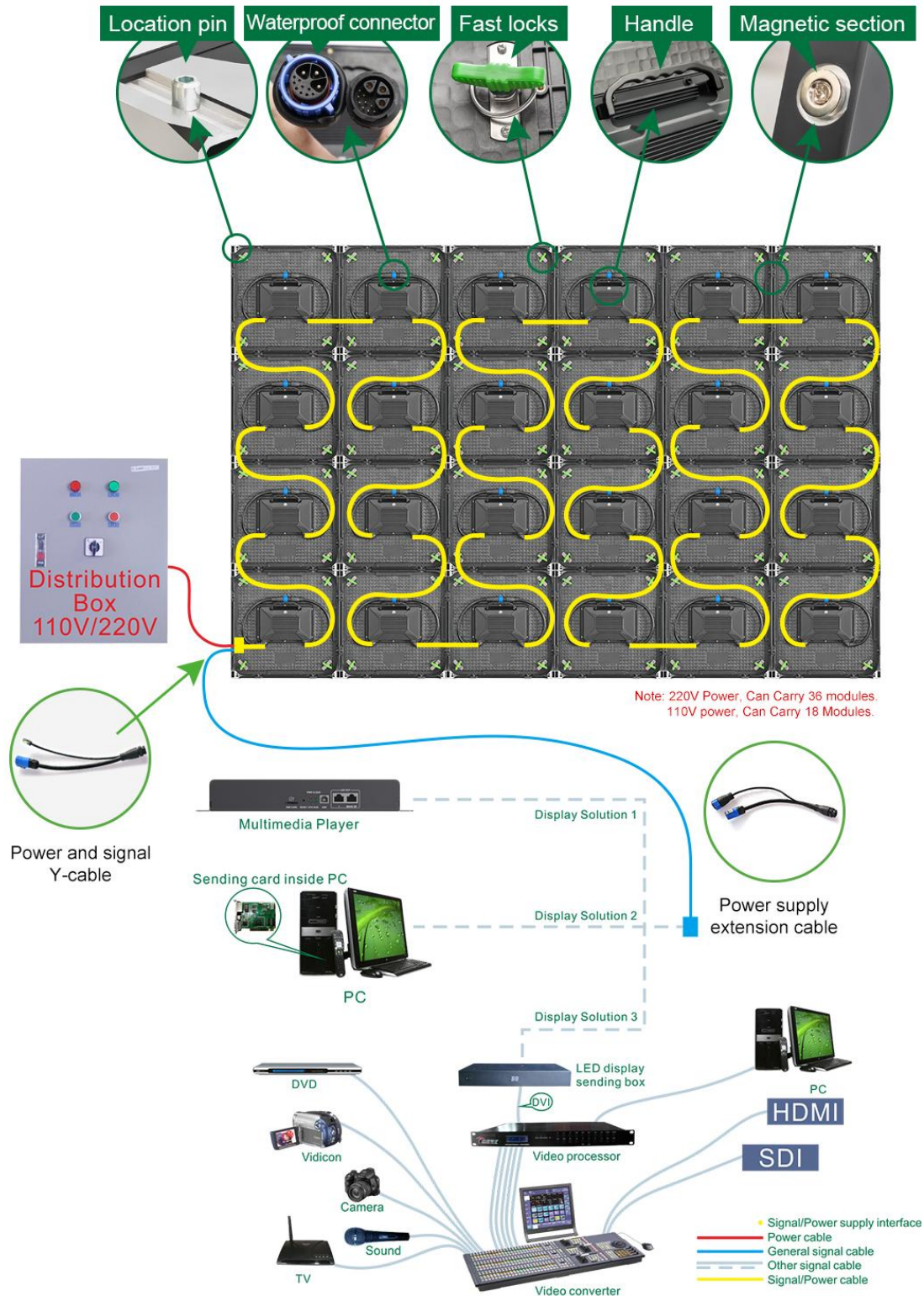

Static Cabinet integration SMALL-SIGNS-ONLY!

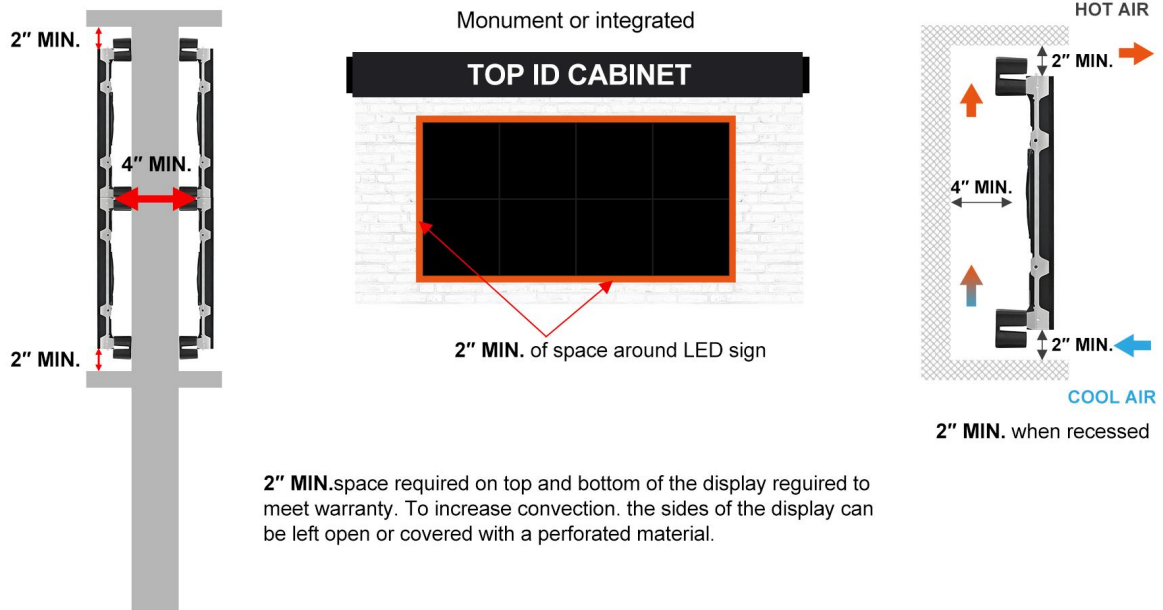

**2" MIN. space required on top and bottom for convection
Do not block ventilation with cross brackets/ supports**

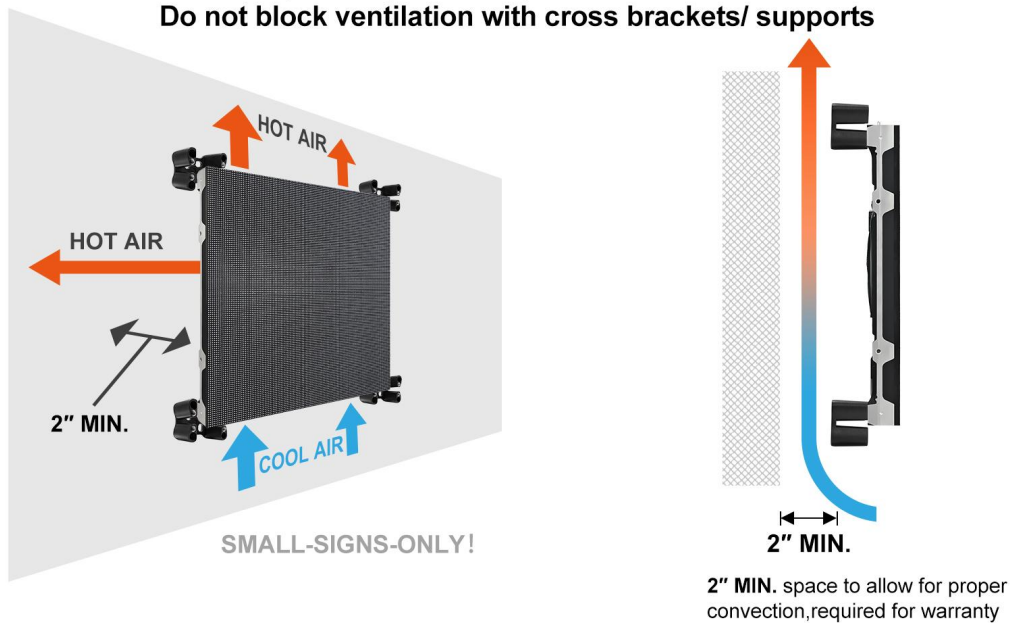

P5 Outdoor Full Color Led Display Specification

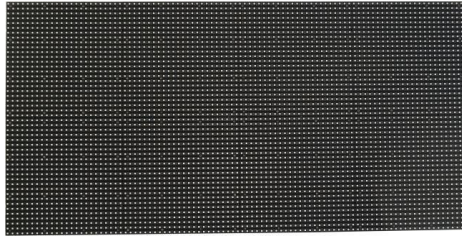

Module



Cabinet

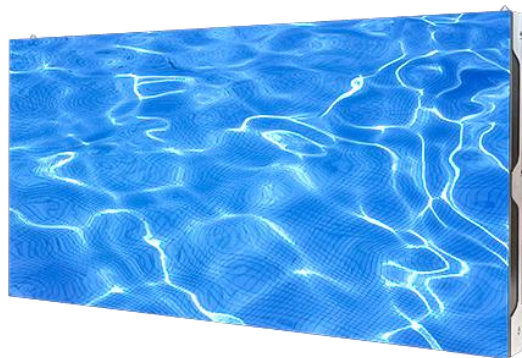

- ◆ Fully enclosed module, higher protection grade with higher stability;
- ◆ 640 * 320mm fully enclosed module, allowing users to quickly assemble signs of different sizes with more flexibility;
- ◆ Thin and light weight module; Weight $\leq 25\text{kg/m}^2$; Small size and light weight, saving large storage and transportation costs;
- ◆ Saving structural costs: Module with fixed bracket=large screen, eliminating bulky cabinet and saving framework costs.
- ◆ Fast installation: Fast lock without screws, and connectors with fast cabling, high efficiency;
- ◆ The two in one power and signal cable can be quickly connected, convenient to connect with beautiful cabling;
- ◆ Wall mounted: Module, power supply, and system front maintenance design can meet various wall mounting conditions;
- ◆ Low noise: No fan design, ensuring a noise level of less than 25 decibels;
- ◆ High protection grade: Front and rear IP66, durable in stormy weather;
- ◆ Dedicated to providing comprehensive solutions for high-end displays, such as outdoor commercial squares, road advertisements, doorstep advertisements, and window displays, etc.

Technical Parameters:

	Item	Specification Parameter
Module Parameter	Pixel Pitch、 Resolution rate、 size	5mm、 128*64 Dots、 640*320mm
	Pixel color、 Pixel LED	1R1G1B、 SMD1921
	Working voltage、 Module Power	DC4.2V、 105W
	Driving IC、 Driving way	ICND2038S、 1/8
	HUB	QP640X320-HUB75(I6)-V1.0
	Cabinet Parameter	Material、 Frame+Module Weight (kg/pcs)
Resolution rate、 size、 Module quantity		128*64Dots、 640*320*75mm、 1*1
Density		40000 Dots/m ²
White balance 、 Color temperature		5000CD/m ² 、 6500-8000K
view angel、 Non-Flatness、 Module interval		H: 110°; V: 110°、 <0.5mm、 <0.5mm
Maximal power/m ² 、 Average power/m ²		≤510W/m ² 、 ≤150W/m ²
Frame frequency、 Refresh frequency、 Gray grade		60Hz、 ≥1920Hz、 13bit
Control system、 System supports		CHIPSHOW、 Windows XP, WIN 7
Working temperature、 Protection grade		-20~50℃、 Front/Back: IP66
*Reference information, different configurations, different parameters		

Package Parameters:

Gross Weight (kg)	68kg (Estimated data, 10pcs /Case)
Outer Package Size	1110*700*500mm (Estimated data, 10pcs /Case)
Packing Material	Flight case



Assembly Sketch Map/Power Cable And Signal Cable Connection Sketch Map:

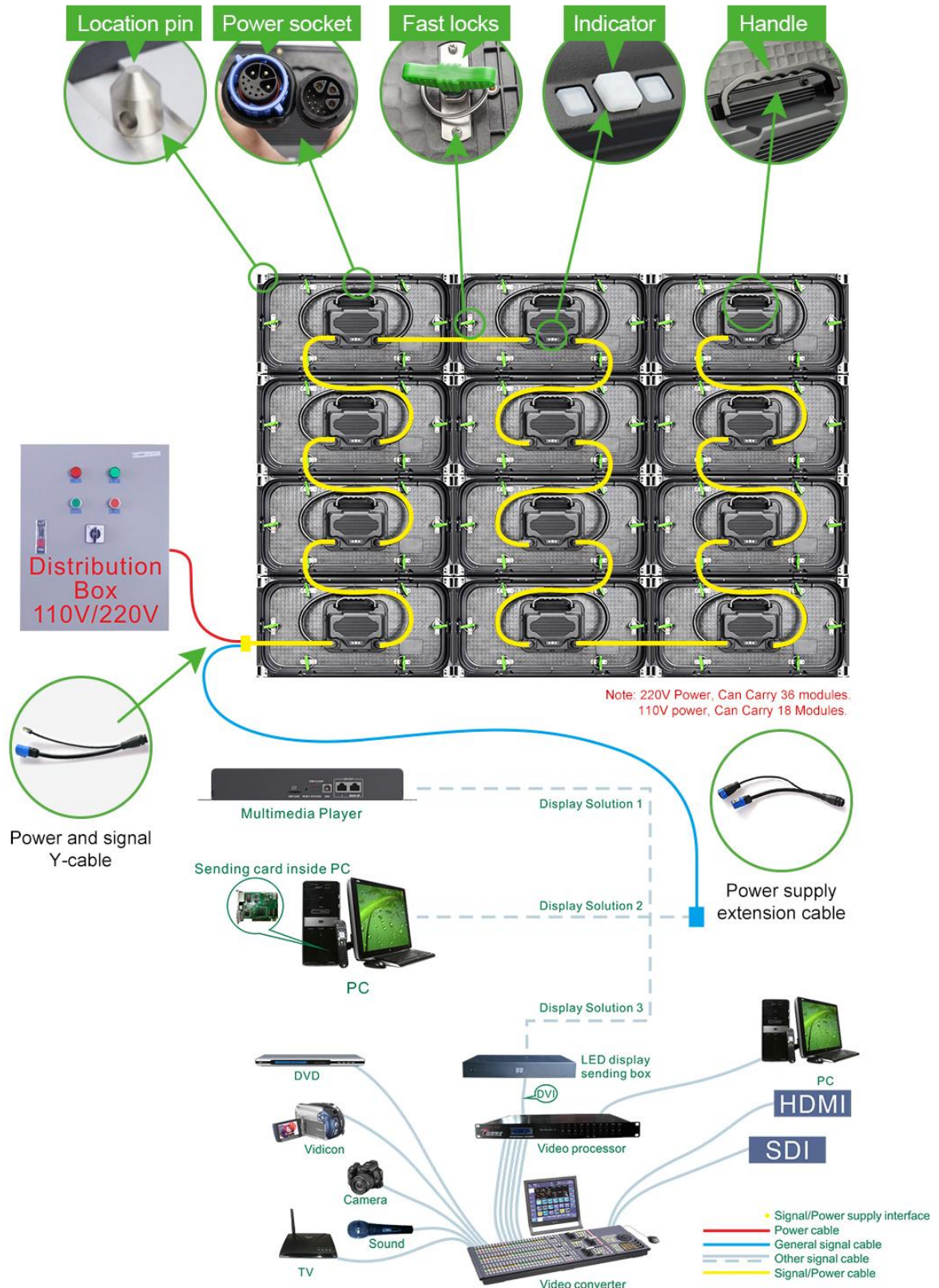

Static Cabinet integration SMALL-SIGNS-ONLY!

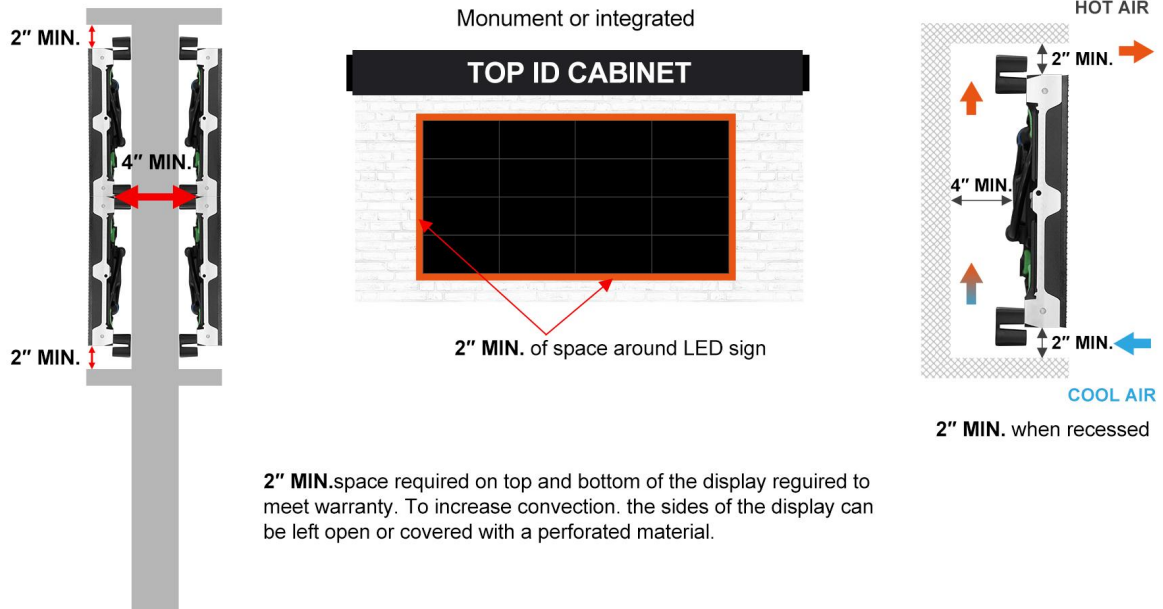

2" MIN. space required on top and bottom for convection
Do not block ventilation with cross brackets/ supports

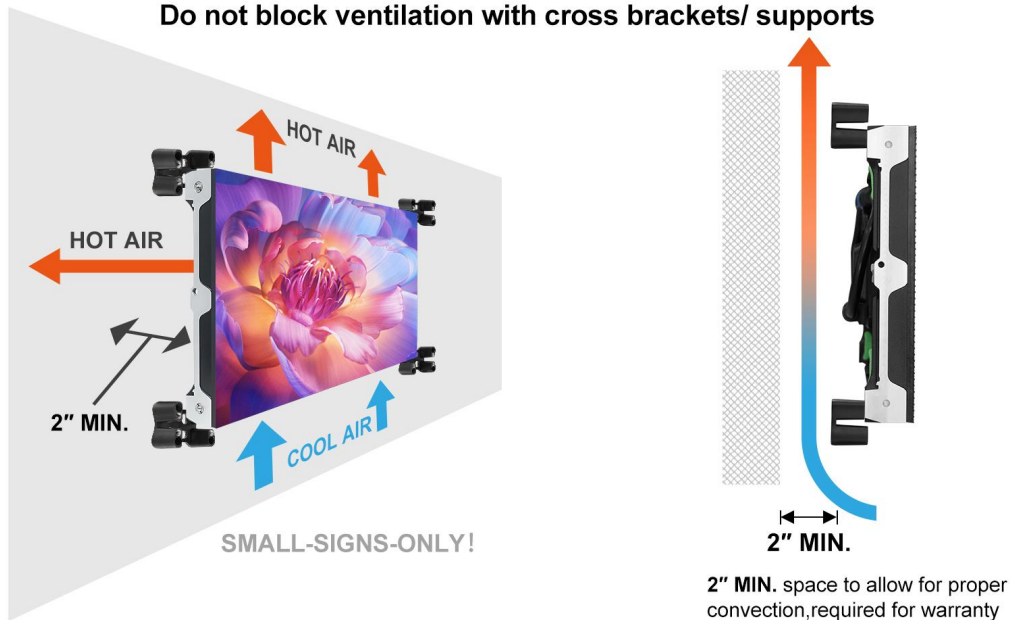

Specifications for P5 dual maintenance full color LED display

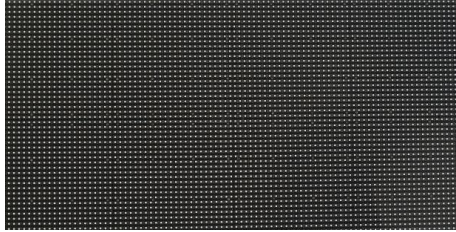

Module

Cabinet



- ◆ High brightness, above 5000 cd/m², with the advantages of good light distribution curve and good angular consistency.
- ◆ Low framework cost: Fully enclosed module+bracket=large screen, saving the cabinet and framework cost;
- ◆ 640 * 320mm large module, good flatness; users can quickly assemble signs of different sizes;
- ◆ Low transportation cost; Light-weighted module; ≤ 25KG/m², small volume and light-weighted, saving storage and transportation costs;
- ◆ Wall mounted design, module, power supply and the control system can be maintained from front and rear, easy for maintenance;
- ◆ Fast installation: Fast lock installation, two in one signal and power cable with fast connection, labor saving, beautiful cabling;
- ◆ Low noise: no fan is designed to ensure the noise less than 25 decibels.
- ◆ High protection level: IP65 front and rear,
- ◆ It is specially designed to provide an overall solution for high-end displays such as outdoor commercial advertisements, road advertisements, door head advertisements and window advertisements.

Technical Parameters :

	Item	Specification Parameter
Module Parameter	Pixel Pitch、 Resolution rate、 size	5mm、 128*64 Dots、 640*320mm
	Pixel color、 Pixel LED	1R1G1B、 SMD1921
	Working voltage、 Module Power	DC4.2V、 105W
	Driving IC、 Driving way	MBI5124GP、 1/8
	HUB	QP640X320-HUB75(I6)-V1.0
Cabinet Parameter	Material、 Frame+Module(kg/pcs)	Aluminum frame、 3.62+11.85kg/PCS
	Resolution rate、 size、 Module quantity	128*192Dots、 640*960*75mm、 1*3
	Density	40000 Dots/m ²
	White balance 、 Color temperature	5000CD/m ² 、 6500-8000K
	view angel、 Non-Flatness、 Module interval	H: 110°; V: 110°、 <0.5mm、 <0.5mm
	Maximal power/m ² 、 Average power/m ²	≤510W/m ² 、 ≤150W/m ²
	Frame frequency、 Refresh frequency、 Gray grade	60Hz、 ≥1920Hz、 13bit
	Control system、 System supports	CHIPSHOW、 Windows XP、 WIN 7
Working temperature、 Protection grade	-20~50℃、 Front/Back: IP65/IP65	
*Reference information, different configurations, different parameters		

Package Parameters :

Gross Weight (kg)	200kg (Estimated data, 12pcs /Case)
Outer Package Size	1020*1250*890mm (Estimated data, 12pcs /Case)
Packing Material	Carton + wooden pallet + pearl cotton



Assembly Sketch Map/Power Cable And Signal Cable Connection Sketch Map:

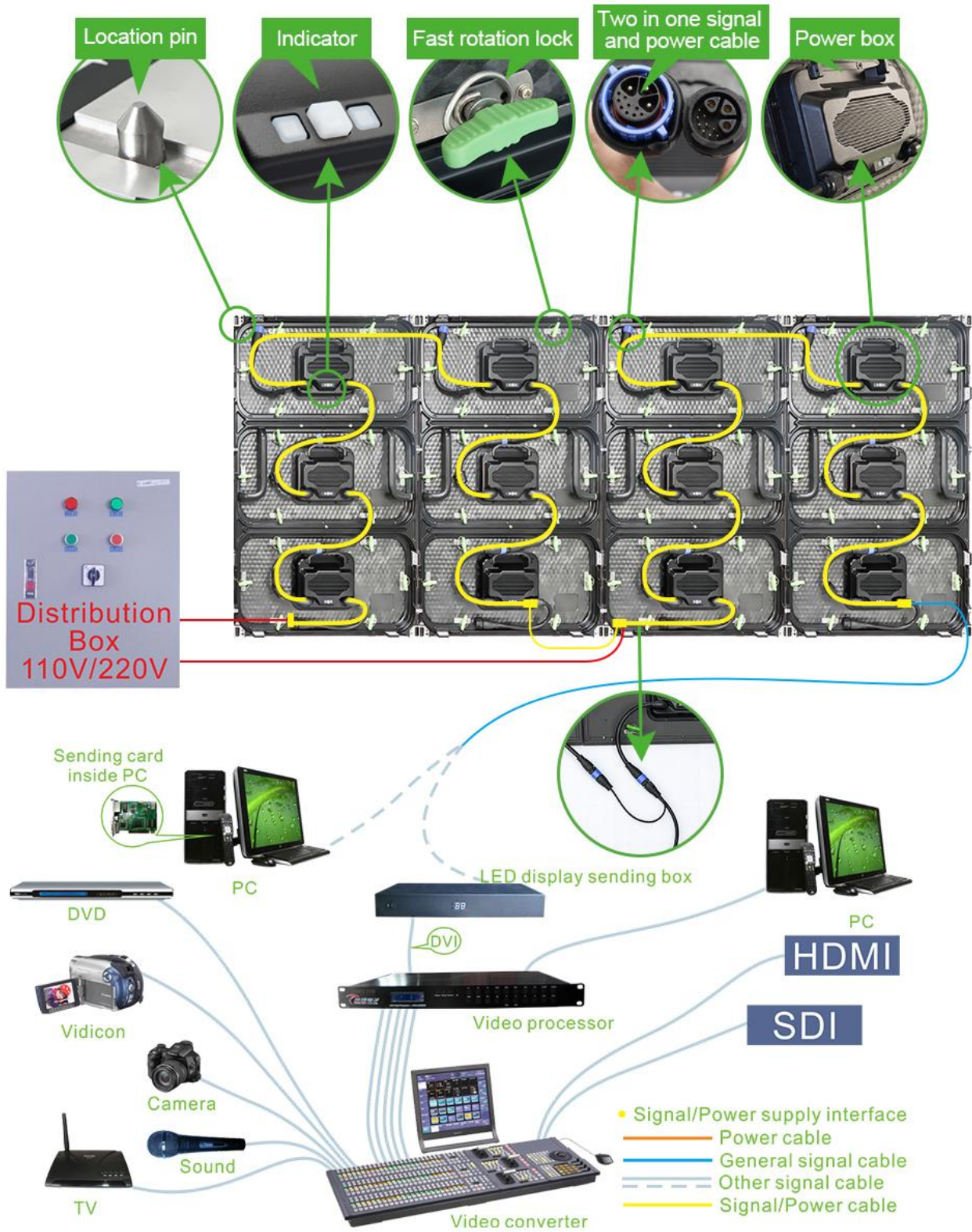

Static Cabinet integration SMALL-SIGNS-ONLY!

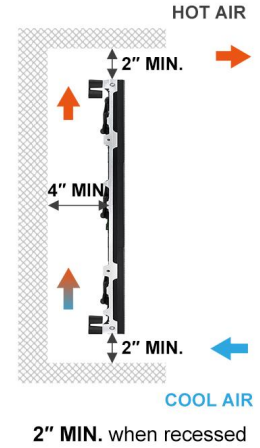
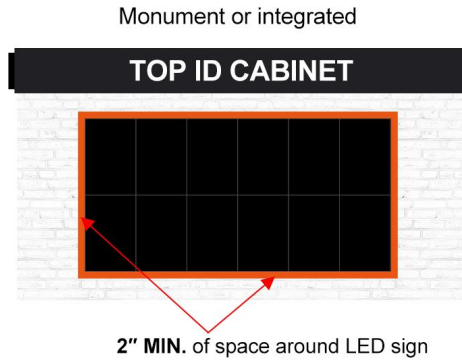
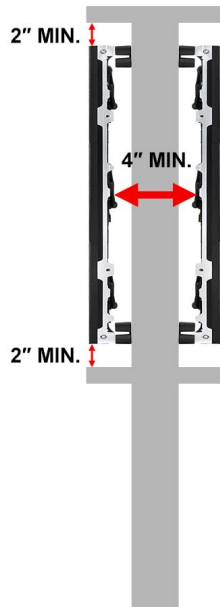

2" MIN. space required on top and bottom of the display required to meet warranty. To increase convection, the sides of the display can be left open or covered with a perforated material.

2" MIN. space required on top and bottom for convection
Do not block ventilation with cross brackets/ supports

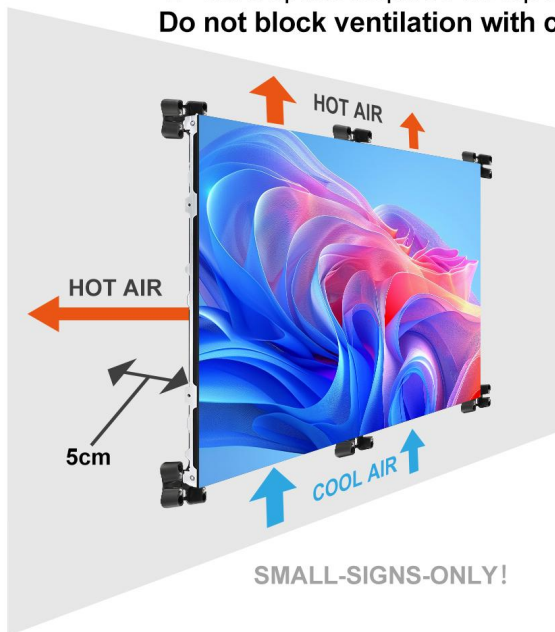

2" MIN. space to allow for proper convection, required for warranty

P6.67 Outdoor Full Color Led Display Specification

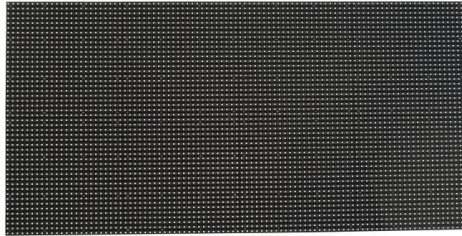

Module



Cabinet

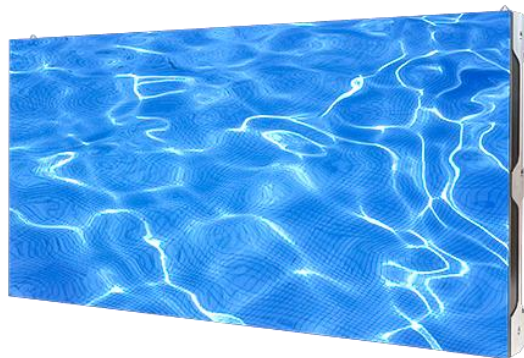

- ◆ Fully enclosed module, higher protection grade with higher stability;
- ◆ 640 * 320mm fully enclosed module, allowing users to quickly assemble signs of different sizes with more flexibility;
- ◆ Thin and light weight module; Weight $\leq 25\text{kg/m}^2$; Small size and light weight, saving large storage and transportation costs;
- ◆ Saving structural costs: Module with fixed bracket=large screen, eliminating bulky cabinet and saving framework costs.
- ◆ Fast installation: Fast lock without screws, and connectors with fast cabling, high efficiency;
- ◆ The two in one power and signal cable can be quickly connected, convenient to connect with beautiful cabling;
- ◆ Wall mounted: Module, power supply, and system front maintenance design can meet various wall mounting conditions;
- ◆ Low noise: No fan design, ensuring a noise level of less than 25 decibels;
- ◆ High protection grade: Front and rear IP66, durable in stormy weather;
- ◆ Dedicated to providing comprehensive solutions for high-end displays, such as outdoor commercial squares, road advertisements, doorstep advertisements, and window displays, etc.

Technical Parameters:

	Item	Specification Parameter
Module Parameter	Pixel Pitch、Resolution rate、size	6.67mm、96*48 Dots、640*320mm
	Pixel color、 Pixel LED	1R1G1B、 SMD2727
	Working voltage、 Module Power	DC4.5V、 125W
	Driving IC、 Driving way	ICND2038S、 1/6
	HUB	QP640X320-HUB43(I6)-A1.2
	Cabinet Parameter	Material、 Frame+Module Weight (kg/pcs)
Resolution rate、 size、 Module quantity		96*48Dots、 640*320*78mm、 1*1
Density		22500 Dots/m ²
White balance 、 Color temperature		5500 CD/m ² 、 6500-8000K
view angel、 Non-Flatness、 Module interval		H: 110°; V: 110°、 <0.5mm、 <0.5mm
Maximal power/m ² 、 Average power/m ²		≤610W/m ² 、 ≤200W/m ²
Frame frequency、 Refresh frequency、 Gray grade		60Hz、 ≥1920Hz、 13bit
Control system、 System supports		CHIPSHOW、 Windows XP、 WIN 7
Working temperature、 Protection grade		-20~50℃、 Front/Back: IP66
*Reference information, different configurations, different parameters		

Package Parameters:

Gross Weight (kg)	68kg (Estimated data,10pcs /Case)
Outer Package Size	1110*700*500mm (Estimated data,10pcs /Case)
Packing Material	Flight case



Assembly Sketch Map/Power Cable And Signal Cable Connection Sketch Map:

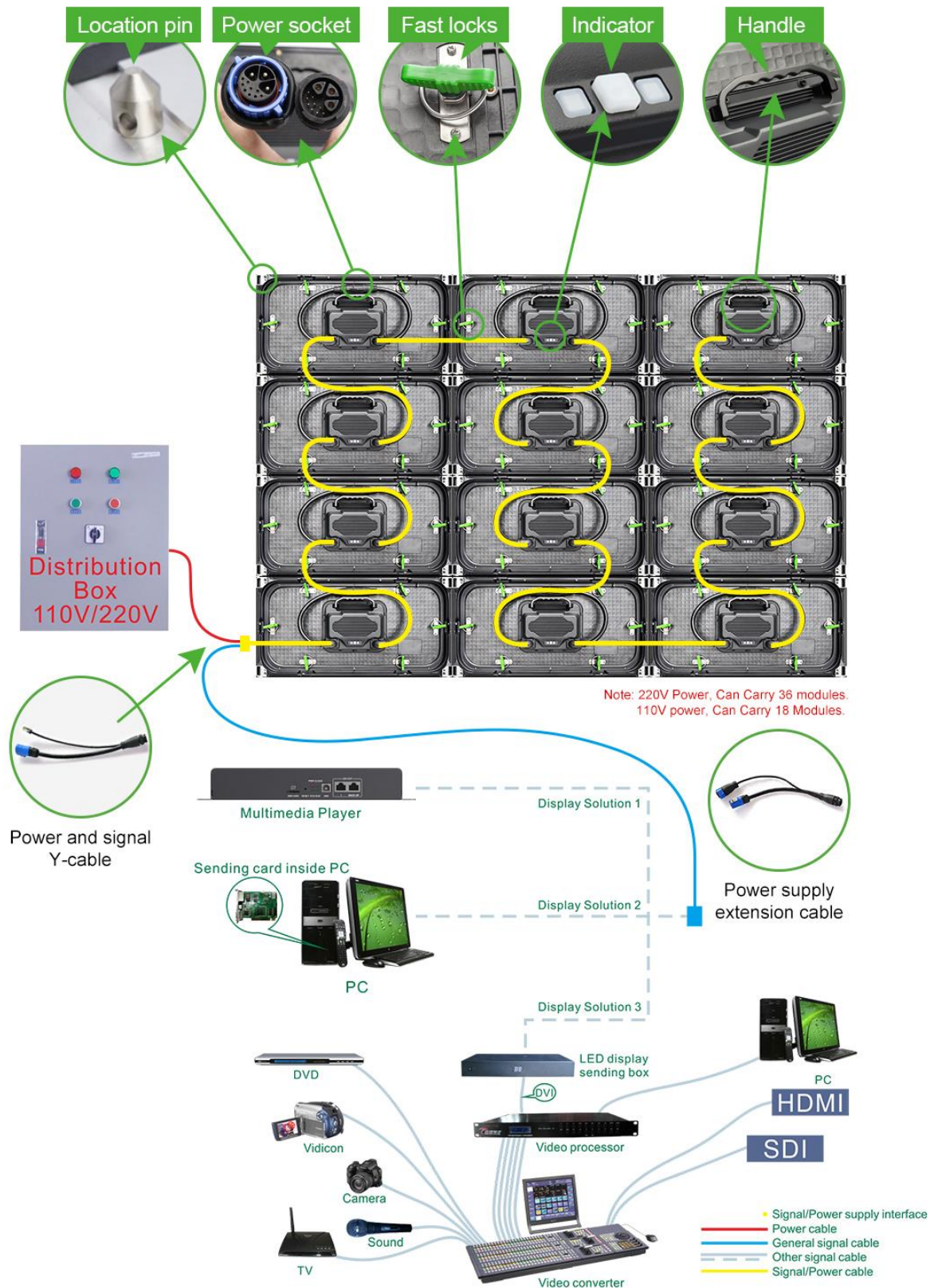

Static Cabinet integration SMALL-SIGNS-ONLY!

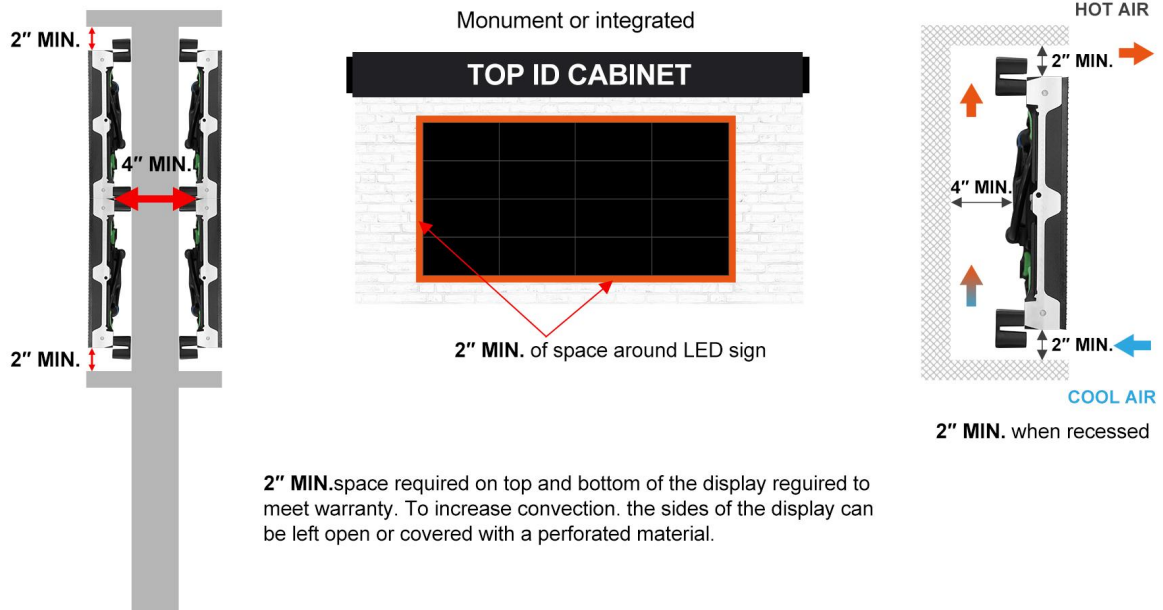

**2" MIN. space required on top and bottom for convection
Do not block ventilation with cross brackets/ supports**

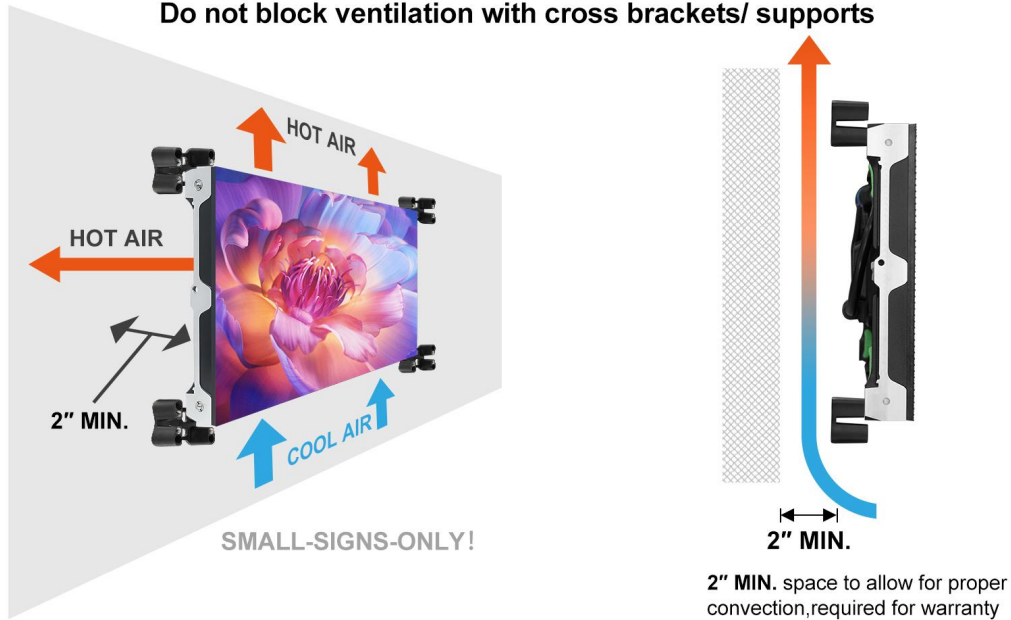

Ultra-Light Full Color LED Smart Display

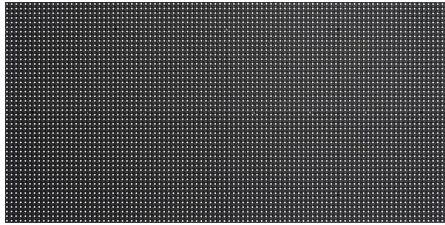

Module

Cabinet



- ◆ **Ultra-High Brightness & Low Power Consumption:** Brightness \leq 11000 cd/m² with average power consumption \leq 160W/m².
- ◆ **Cost-Effective Structure:** Fully enclosed module + bracket = large screen, saving cabinets and steel structure costs.
- ◆ **640×320mm Large Module:** Ensures excellent flatness and allows to assemble signage of various sizes quickly and flexibly.
- ◆ **Low Transportation Costs:** Lightweight module (\leq 26kg/m²) with compact size reduces storage and shipping expenses.
- ◆ **Wall-Mount Installation:** Modules, power supplies, and systems support dual sides maintenance for easy servicing.
- ◆ **Fast Installation:** Fast-lock and 2-in-1 signal & power cable enable installation quickly, saving labor while ensuring neat cabling layout.
- ◆ **Low Noise Operation:** Fanless design ensures noise levels remain below 25dB.
- ◆ **High Protection Level:** IP66 front and rear, resistant to harsh weather conditions.
- ◆ **Tailored for Outdoor Applications:** Ideal for commercial advertising, highway billboards, storefront signage, and store window displays, etc. To delivering high-end visual solutions.

Technical Parameters:

	Item	Specification Parameter
Module Parameter	Pixel Pitch、Resolution rate、size	6.67mm、96*48 Dots、640*320mm
	Pixel color、 Pixel LED	1R1G1B、 SMD4535
	Working voltage、 Module Power	DC4.2V、 105W
	Driving IC、 Driving way	ICND2153、 1/6
	HUB	QP640X320-HUB75(AXS)-A2
	Cabinet Parameter	Material、 Cabinet Weight(kg/Cabinet)
Resolution rate、 size、 Module quantity		192*96Dots、 640*320*75mm、 1*1
Density		22500 Dots/m ²
White balance 、 Color temperature		11800 CD/m ² 、 6500-8000K
view angel、 Non-Flatness、 Module interval		H: 100°; V: 100°、 <0.5mm、 <0.5mm
Maximal power/m ² 、 Average power/m ²		510W/m ² 、 160W/m ²
Frame frequency、 Refresh frequency、 Gray grade		60Hz、 3840Hz、 13bit
Control system、 System supports		CHIPSHOW、 Windows XP, WIN 7
Working temperature、 Protection grade		-20~50℃、 Front/Back: IP66
*Reference information, different configurations, different parameters		

Package Parameters:

Gross Weight (kg)	60kg (Estimated data, 10pcs /Case)
Outer Package Size	1000*680*550mm (Estimated data, 10pcs /Case)
Packing Material	Flight cases + pearl cotton * Packaging for reference only, Please refer to the actual order.



Assembly Sketch Map/Power Cable And Signal Cable Connection Sketch Map:

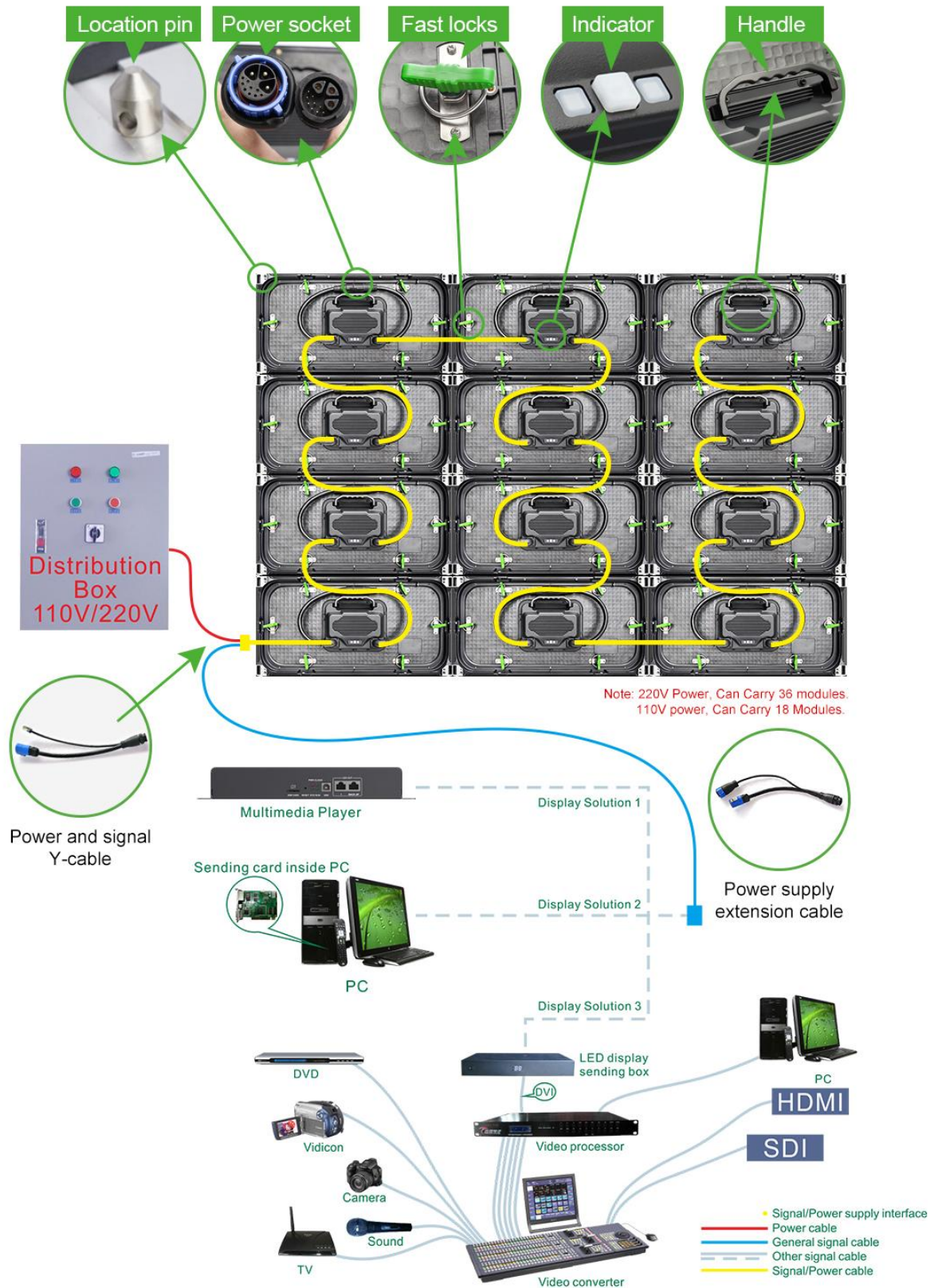

Static Cabinet integration SMALL-SIGNS-ONLY!

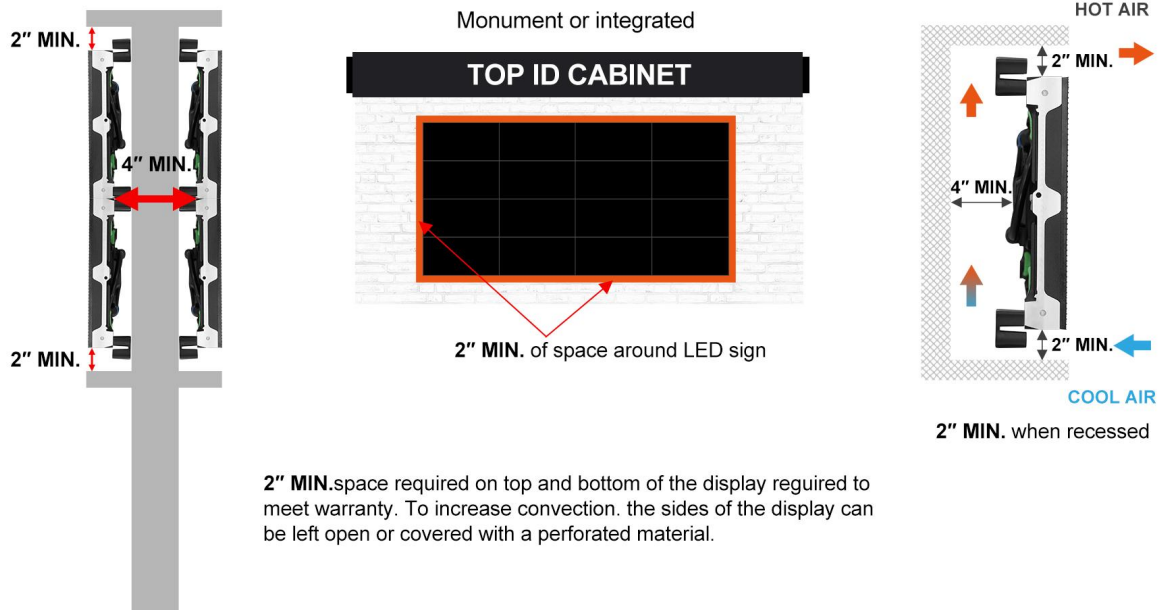

**2" MIN. space required on top and bottom for convection
Do not block ventilation with cross brackets/ supports**

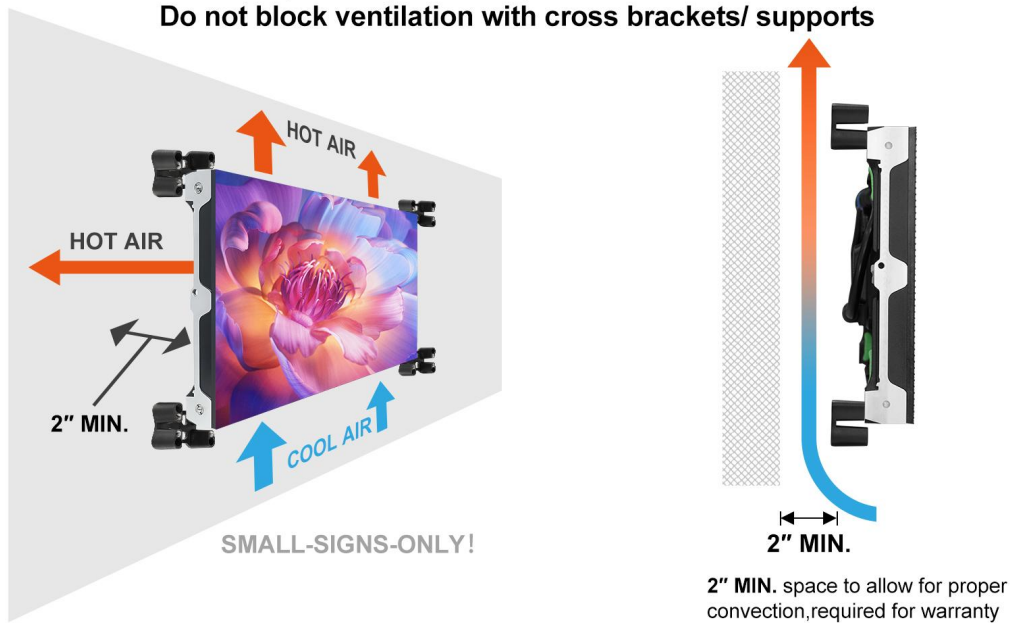

P6.67 Outdoor Full Color Led Display Specification

V20211212

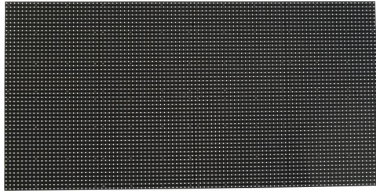

Module

Cabinet



- 1.Fully modular design 1' × 2' for easy assembly and repair**
- 2.Built-in receiving card and power supply with data memory**
- 3.Fully sealed components, simplified waterproof connections**
- 4.Fan-less nature cooling**
- 5.Innovative 10mm DIP pixel for maximum brightness**
- 6.A simple frame needed only, thinnest and lightest display available**
- 7.Be able to increase display size anytime**

Technical Parameters:

	Item	Specification Parameter
Module Parameter	Pixel Pitch、Resolution rate、size	6.67mm、96*48 Dots、640*320mm
	Pixel color、 Pixel LED	1R1G1B、 SMD2727
	Working voltage、 Module Power	DC4.2V、 125W
	Driving IC、 Driving way	ICN2069GP、 1/6
	HUB	P6.67 Signal HUB(AXS)-V1.2
Cabinet Parameter	Material、 Cabinet Weight、	Aluminum、 16.5kg/Cabinet
	Resolution rate、 size、 Module quantity	96*144Dots、 640*960*146mm、 1*3
	Density	22500 Dots/m ²
	White balance 、 Color temperature	5500 CD/m ² 、 6500-8000K
	view angel、 Non-Flatness、 Module interval	H: 120°; V: 120°、 <0.5mm、 <0.5mm
	Maximal power/m ² 、 Average power/m ²	≤650W/m ² 、 ≤210W/m ²
	Frame frequency、 Refresh frequency、 Gray grade	60Hz、 ≥1920Hz、 13bit
	Control system、 System supports	CHIPSHOW、 Windows XP, WIN 7
	Working temperature、 Protection grade	-20~50℃、 Front/Back: IP65/IP65

Package Parameters:

Gross Weight (kg)	185kg (Estimated data,10pcs /Case)
Outer Package Size	1030*1820*820mm (Estimated data,10pcs /Case)
Packing Material	Carton+Pearl cotton+wooden pallet



Assembly Sketch Map/Power Cable And Signal Cable Connection Sketch Map:

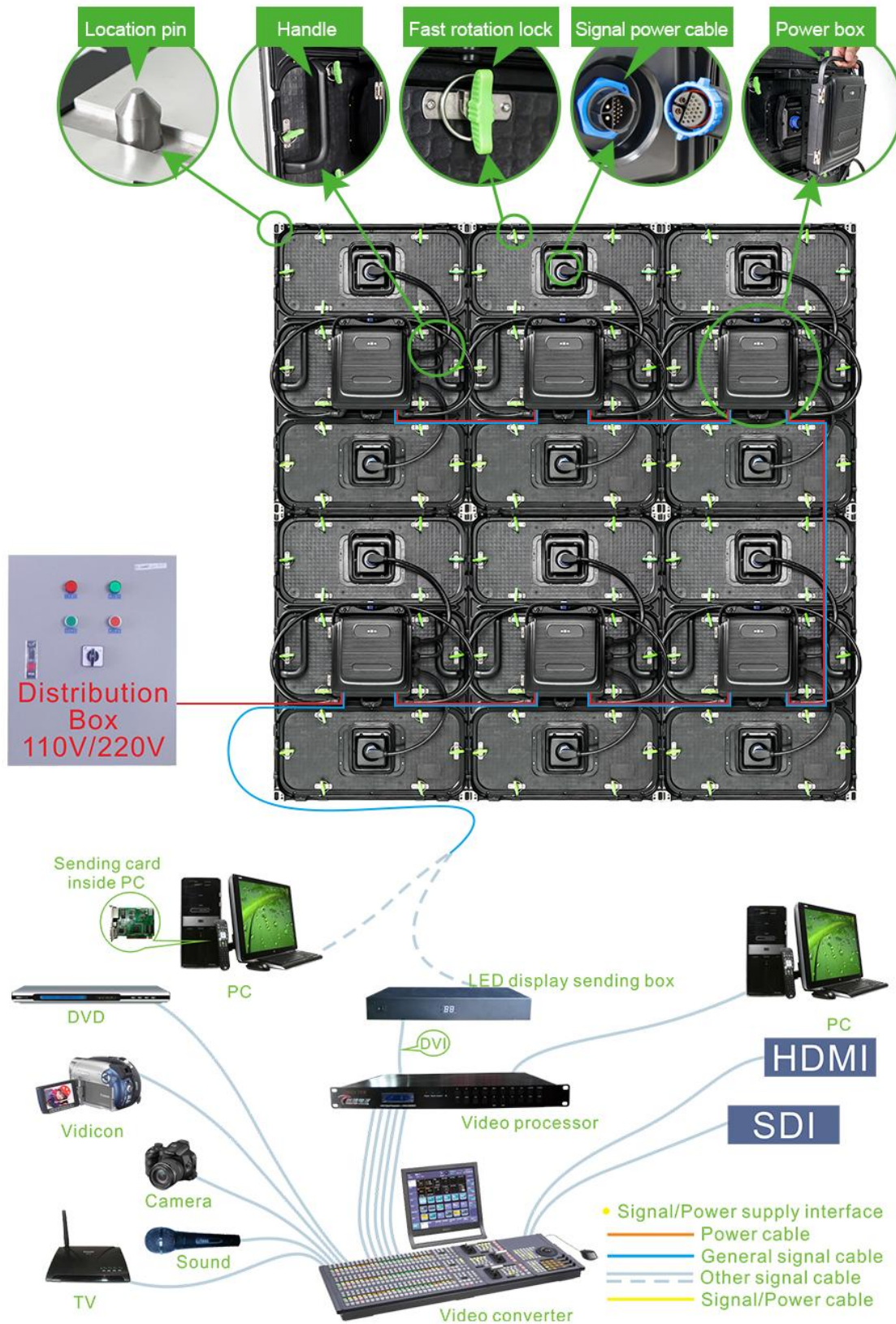

Static Cabinet integration SMALL-SIGNS-ONLY!

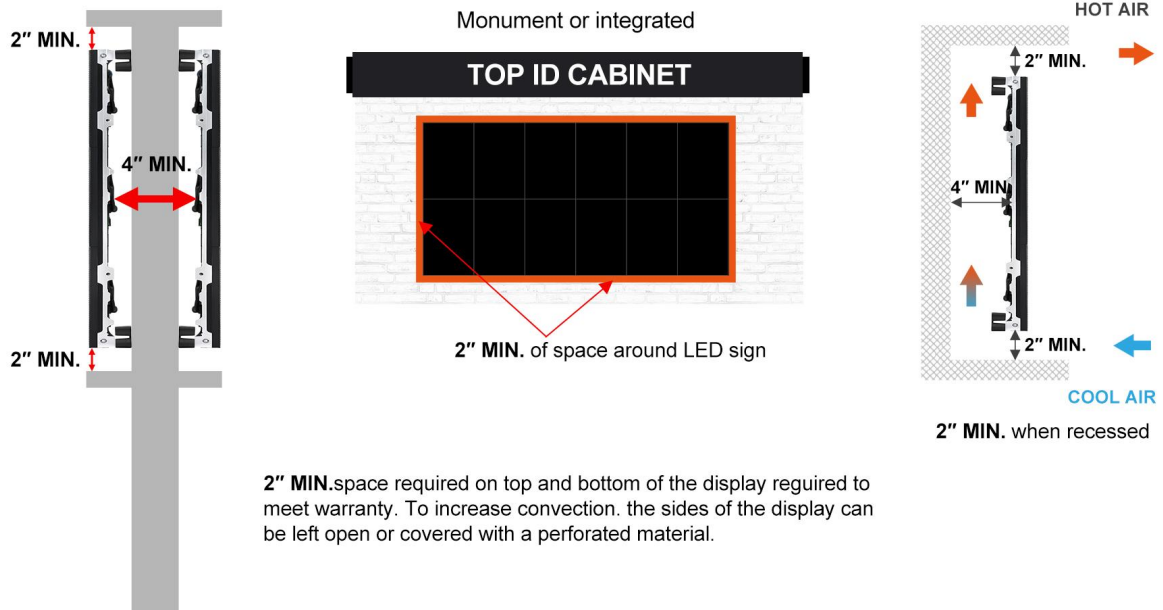

**2" MIN. space required on top and bottom for convection
Do not block ventilation with cross brackets/ supports**

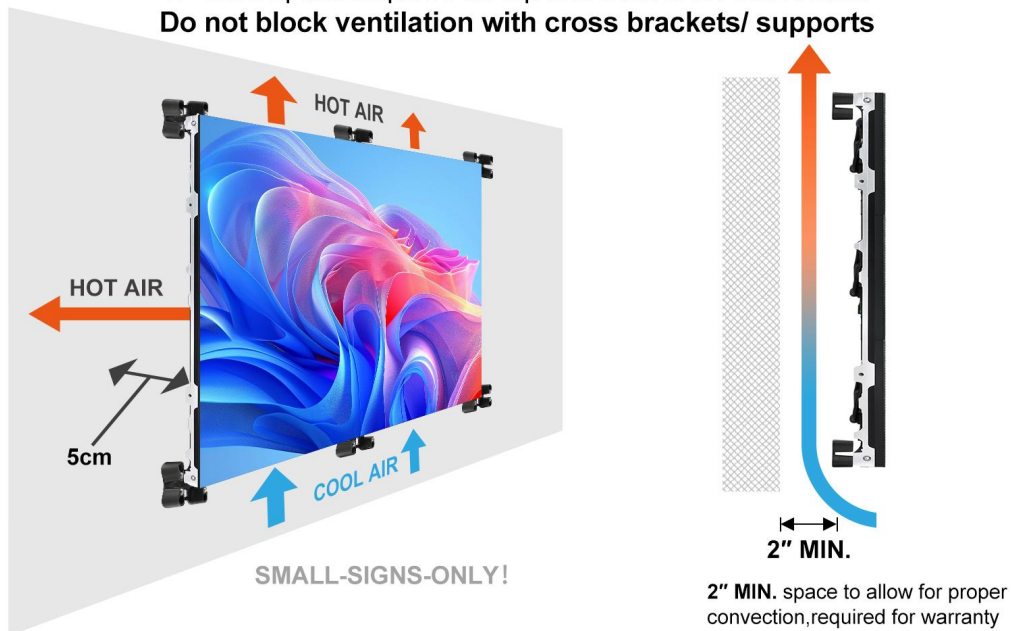

Specifications for Ultra-bright Full color Smart LED display

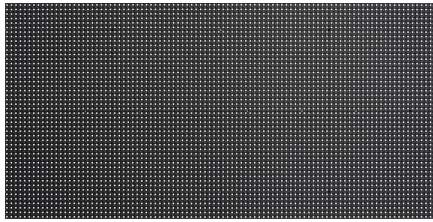

Module

SMD2727(spherical)



Cabinet



- ◆ New ultra-bright and energy-saving smart LED display; Brightness $\leq 11000\text{cd}/\text{m}^2$; Average power consumption $\leq 140\text{W}/\text{m}^2$;
- ◆ Low framework cost: Fully enclosed module+bracket=large screen, saving the cabinet and framework cost;
- ◆ 640 * 320mm large module, good flatness; users can quickly assemble signs of different sizes;
- ◆ Low transportation cost; Light-weighted module; $\leq 26\text{KG}/\text{m}^2$, small volume and light-weighted, saving storage and transportation costs;
- ◆ Wall mounted design, module, power supply and the control system can be maintained from front and rear, easy for maintenance;
- ◆ Fast installation: Fast lock installation, two in one signal and power cable with fast connection, labor saving, beautiful cabling;
- ◆ Low noise: no fan is designed to ensure the noise less than 25 decibels.
- ◆ High protection level: IP66 front and rear,
- ◆ It is specially designed to provide an overall solution for high-end displays such as outdoor commercial advertisements, road advertisements, door head advertisements and window advertisements.

Technical Parameters:

	Item	Specification Parameter
Module Parameter	Pixel Pitch、 Resolution rate、 size	6.67mm、 48*96 Dots、 640*320mm
	Pixel color、 Pixel LED	1R1G1B、 SMD2727 (spherical)
	Working voltage、 Module Power	DC4.2V、 92W
	Driving IC、 Driving way	ICND2069、 1/6
	HUB	QP640X320-HUB43(I6)-A1.2
Cabinet Parameter	Material、 Frame+Module(kg/pcs)	Aluminum frame、 1.29+4.1kg/PCS
	Resolution rate、 size、 Module quantity	192*144Dots、 640*320*75mm、 1*1
	Density	22500 Dots/m ²
	White balance 、 Color temperature	≤11000 CD/m ² 、 6500-8000K
	view angel、 Non-Flatness、 Module interval	H: 90°; V: 90°、 <0.5mm、 <0.5mm
	Maximal power/m ² 、 Average power/m ²	455W/m ² 、 140W/m ²
	Frame frequency、 Refresh frequency、 Gray grade	60Hz、 3840Hz、 13bit
	Control system、 System supports	CHIPSHOW、 Windows XP, WIN 7
	Working temperature、 Protection grade	-20~50°C、 Front/Back: IP66
*Reference information, different configurations, different parameters		

Package Parameters:

Gross Weight (kg)	60kg (Estimated data,10pcs /Case)
Outer Package Size	1000*680*550mm (Estimated data,10pcs /Case)
Packing Material	Flight case+Pearl Cotton



Assembly Sketch Map/Power Cable And Signal Cable Connection Sketch Map:

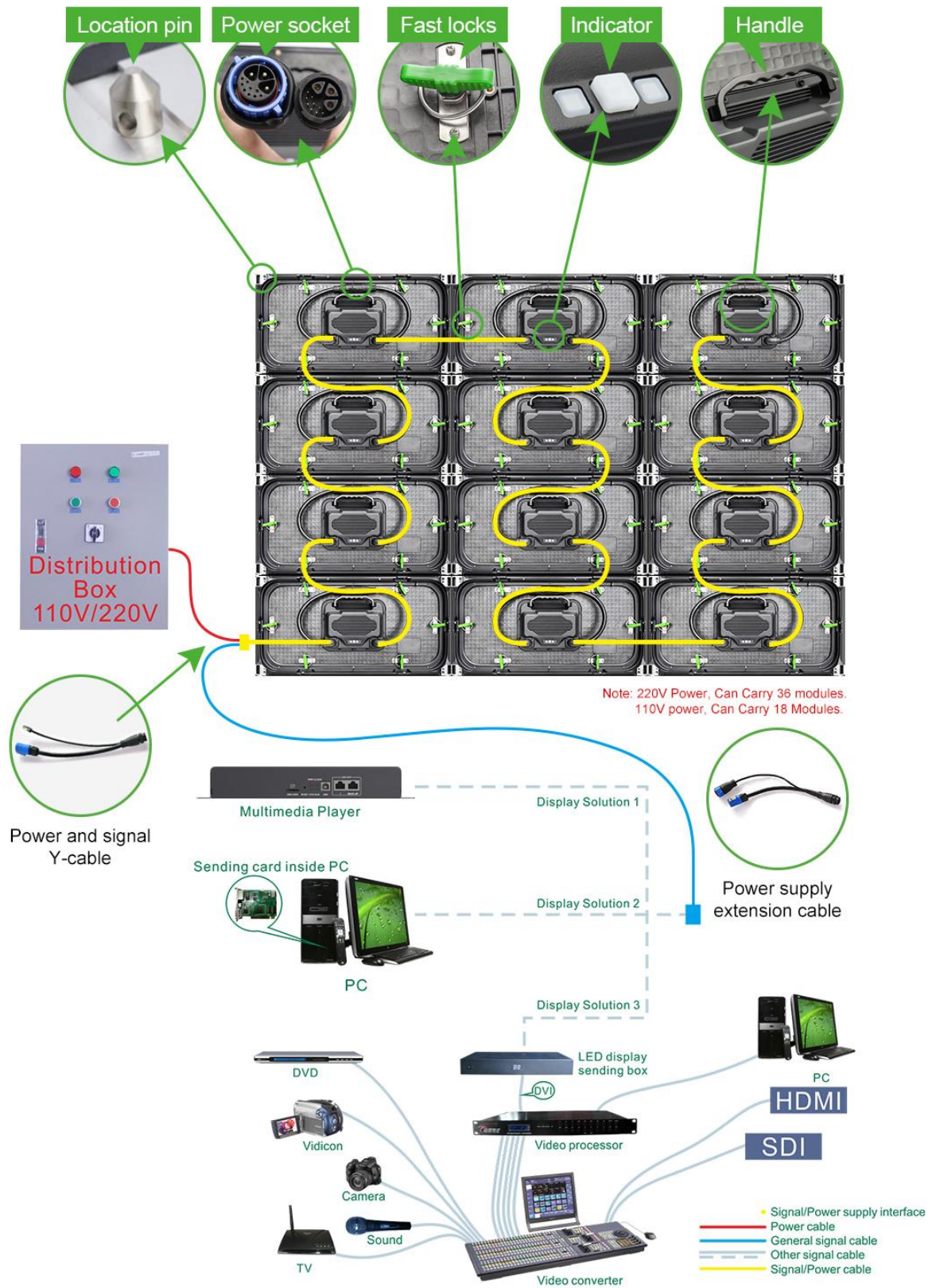

Static Cabinet integration SMALL-SIGNS-ONLY!

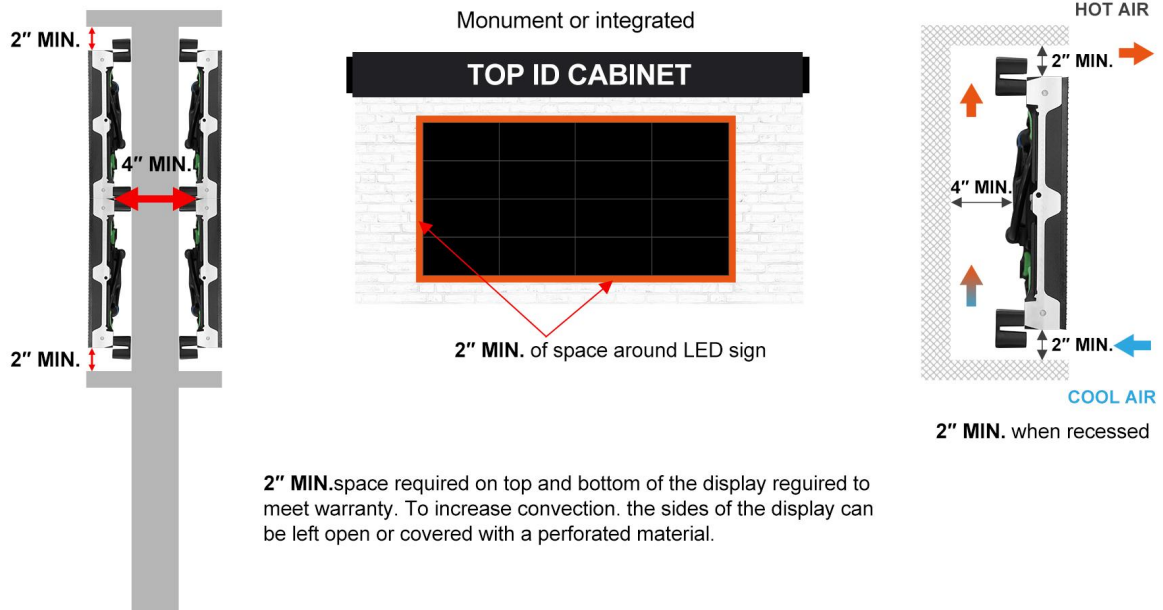

**2" MIN. space required on top and bottom for convection
Do not block ventilation with cross brackets/ supports**

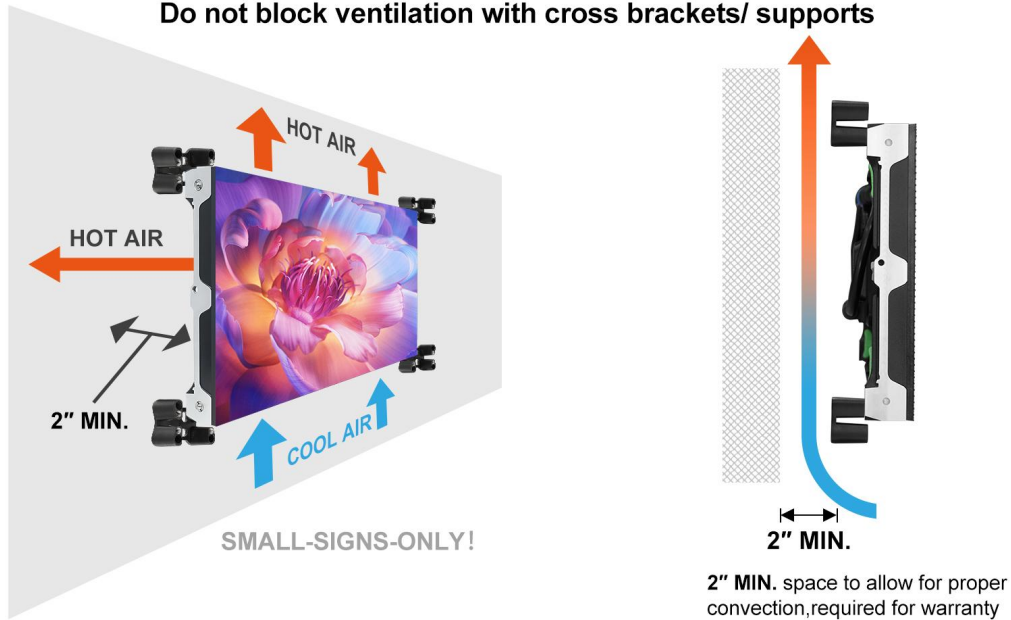

Specifications for Ultra-bright Full color Smart LED display

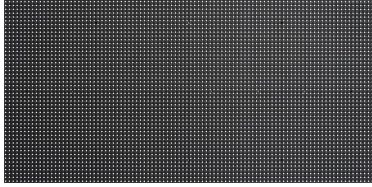

Module

SMD2727(spherical)

Cabinet



- ◆ New ultra-bright and energy-saving smart LED display; Brightness $\leq 11000\text{cd}/\text{m}^2$; Average power consumption $\leq 140\text{W}/\text{m}^2$;
- ◆ Low framework cost: Fully enclosed module+bracket=large screen, saving the cabinet and framework cost;
- ◆ 640 * 320mm large module, good flatness; users can quickly assemble signs of different sizes;
- ◆ Low transportation cost; Light-weighted module; $\leq 26\text{KG}/\text{m}^2$, small volume and light-weighted, saving storage and transportation costs;
- ◆ Wall mounted design, module, power supply and the control system can be maintained from front and rear, easy for maintenance;
- ◆ Fast installation: Fast lock installation, two in one signal and power cable with fast connection, labor saving, beautiful cabling;
- ◆ Low noise: no fan is designed to ensure the noise less than 25 decibels.
- ◆ High protection level: IP65 front and rear,
- ◆ It is specially designed to provide an overall solution for high-end displays such as outdoor commercial advertisements, road advertisements, door head advertisements and window advertisements.

Technical Parameters:

	Item	Specification Parameter
Module Parameter	Pixel Pitch、Resolution rate、size	6.67mm、48*96 Dots、640*320mm
	Pixel color、 Pixel LED	1R1G1B、 SMD2727 (spherical)
	Working voltage、 Module Power	DC4.2V、 92W
	Driving IC、 Driving way	ICND2069、 1/6
	HUB	QP640X320-HUB43(I6)-A1.2
	Cabinet Parameter	Material、 Cabinet Weight(kg/Cabinet)
Resolution rate、 size、 Module quantity		192*144Dots、 640*960*75mm、 1*3
Density		22500 Dots/m ²
White balance 、 Color temperature		≤11000 CD/m ² 、 6500-8000K
view angel、 Non-Flatness、 Module interval		H: 90°; V: 90°、 <0.5mm、 <0.5mm
Maximal power/m ² 、 Average power/m ²		455W/m ² 、 140W/m ²
Frame frequency、 Refresh frequency、 Gray grade		60Hz、 3840Hz、 13bit
Control system、 System supports		CHIPSHOW、 Windows XP, WIN 7
Working temperature、 Protection grade		-20~50°C、 Front/Back: IP65/IP54
*Reference information, different configurations, different parameters		

Package Parameters:

Gross Weight (kg)	200kg (Estimated data, 10pcs /Case)
Outer Package Size	1030*1820*820mm (Estimated data, 10pcs /Case)
Packing Material	Flight case+Pearl Cotton



Assembly Sketch Map/Power Cable And Signal Cable Connection Sketch Map:

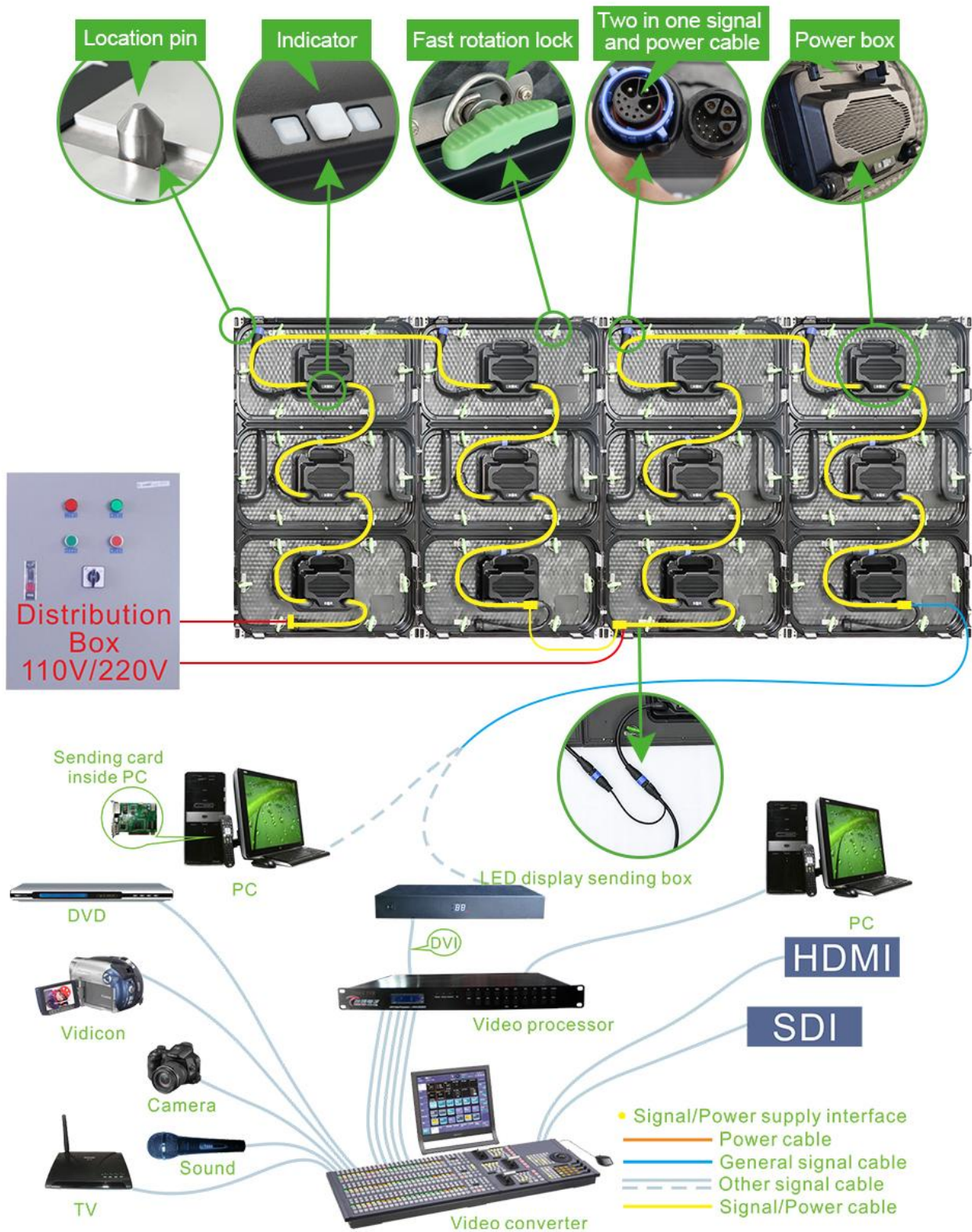

Static Cabinet integration SMALL-SIGNS-ONLY!

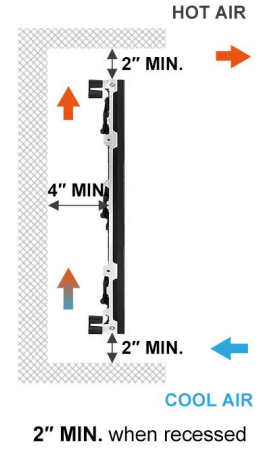
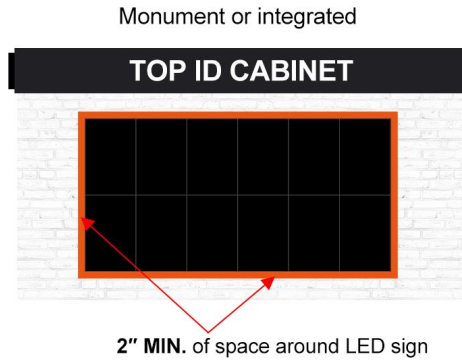
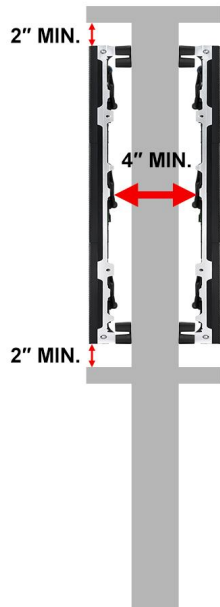

2" MIN. space required on top and bottom of the display required to meet warranty. To increase convection, the sides of the display can be left open or covered with a perforated material.

2" MIN. space required on top and bottom for convection
Do not block ventilation with cross brackets/ supports

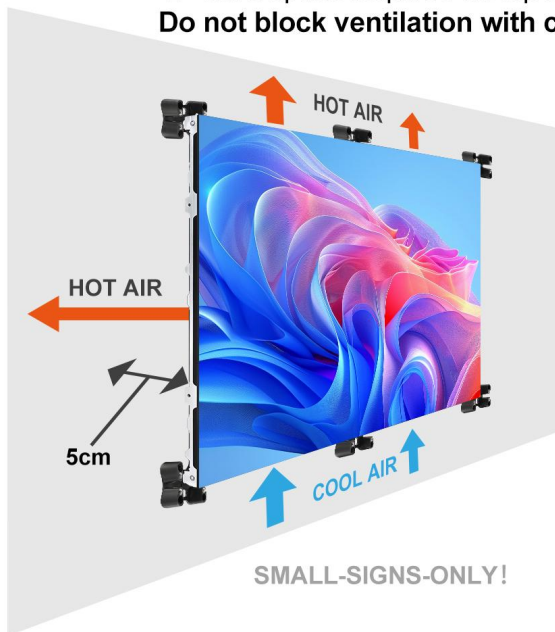

2" MIN. space to allow for proper convection, required for warranty

Specifications for P5 dual maintenance full color LED display

V:2022.07.11

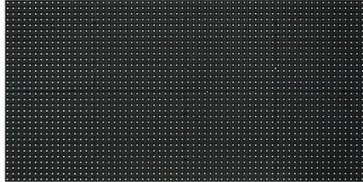

Module



Cabinet



- ◆ Integrated Module: with build-in control card、 power supply, each module is as a small cabinet. Don't need protection from cabinet like traditional way, which minimizes the faulty rate and enhances the stability.
- ◆ Simple support design: the module only needs simple frame to support and fix, saving a lot of installation costs.
- ◆ Flexible on screen dimension: The integrated module dimension is 640*320mm, the users can make it any size of screens.
- ◆ Light weight: Total weight of modules is 25KG/m².
- ◆ Low noise: without fans, the noise is <25dB.
- ◆ Quick setup: Use fast locks and connectors for fast installation, no screws needed.
- ◆ Front and rear access: customized sub-frame ensures fast service and installation.
- ◆ IP65 rating for front and rear.

Technical Parameters:

	Item	Specification Parameter
Module Parameter	Pixel Pitch、Resolution rate、size	5mm、128*64 Dots、640*320mm
	Pixel color、 Pixel LED	1R1G1B、 SMD1921
	Working voltage、 Module Power	DC4.2V、 105W
	Driving IC、 Driving way	MBI5124GP、 1/8
	HUB	QP640X320-HUB75(I6)-V1.0
Cabinet Parameter	Material、 Cabinet Weight(kg/Cabinet)	Cast aluminum frame 、 16.5Kg/PCS
	Resolution rate、 size、 Module quantity	128*192 Dots、 640*960*146mm、 1*3
	Density	40000 Dots/m ²
	White balance 、 Color temperature	5000 CD/m ² 、 6500-8000K
	view angel、 Non-Flatness、 Module interval	H: 110°; V: 110°、 <0.5mm、 <0.5mm
	Maximal power/m ² 、 Average power/m ²	≤520W/m ² 、 ≤170W/m ²
	Frame frequency、 Refresh frequency、 Gray grade	60Hz、 ≥1920Hz、 13bit
	Control system、 System supports	CHIPSHOW、 Windows XP, WIN 7
	Working temperature、 Protection grade	-20~50℃、 Front/Back: IP65
*Reference information, different configurations, different parameters		

Package Parameters:

Gross Weight (kg)	185kg (Estimated data, 10pcs /Case)
Outer Package Size	1030*1820*820mm (Estimated data, 10pcs /Case)
Packing Material	Carton + wooden pallet + pearl cotton



Assembly Sketch Map/Power Cable And Signal Cable Connection Sketch Map:

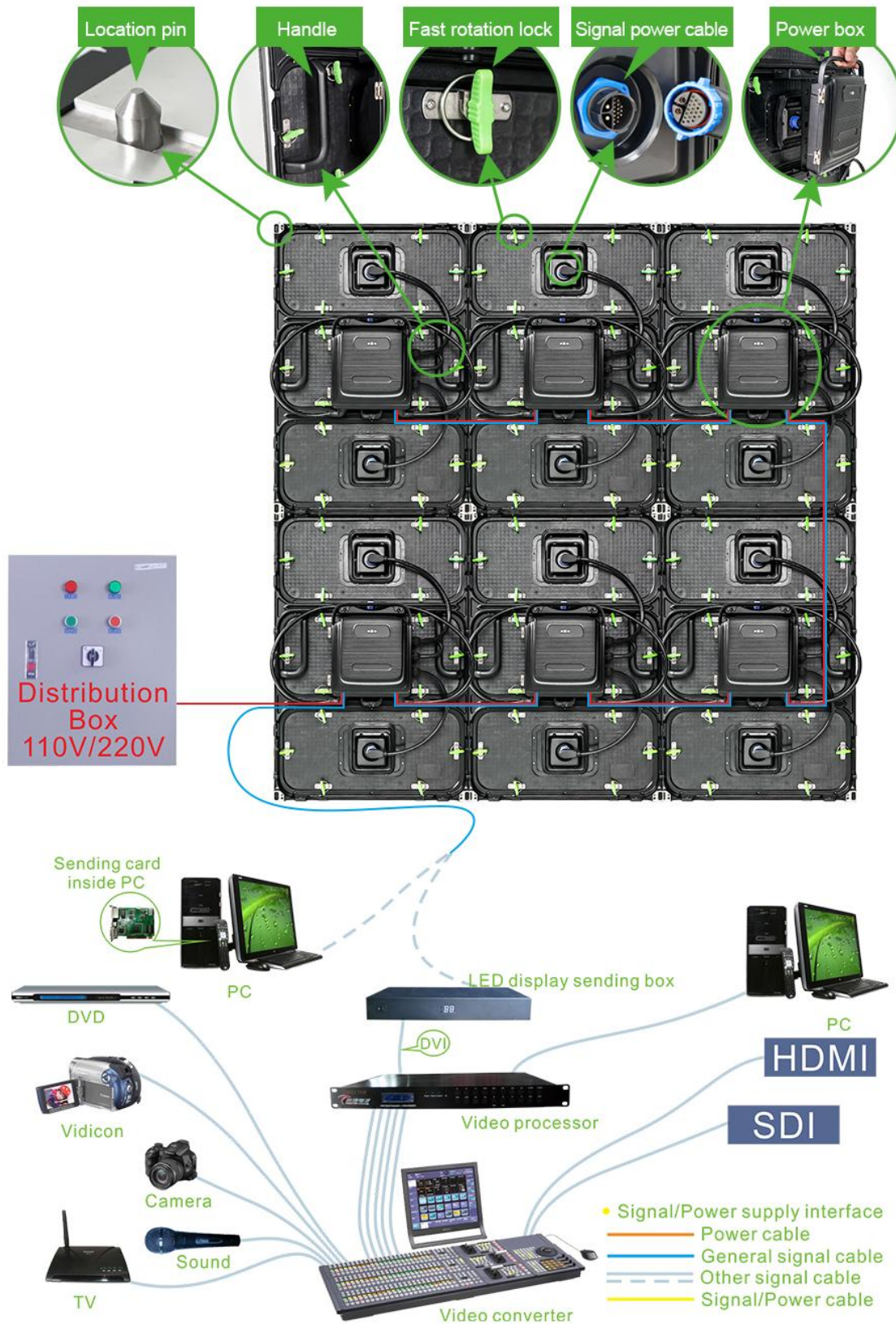

Static Cabinet integration SMALL-SIGNS-ONLY!

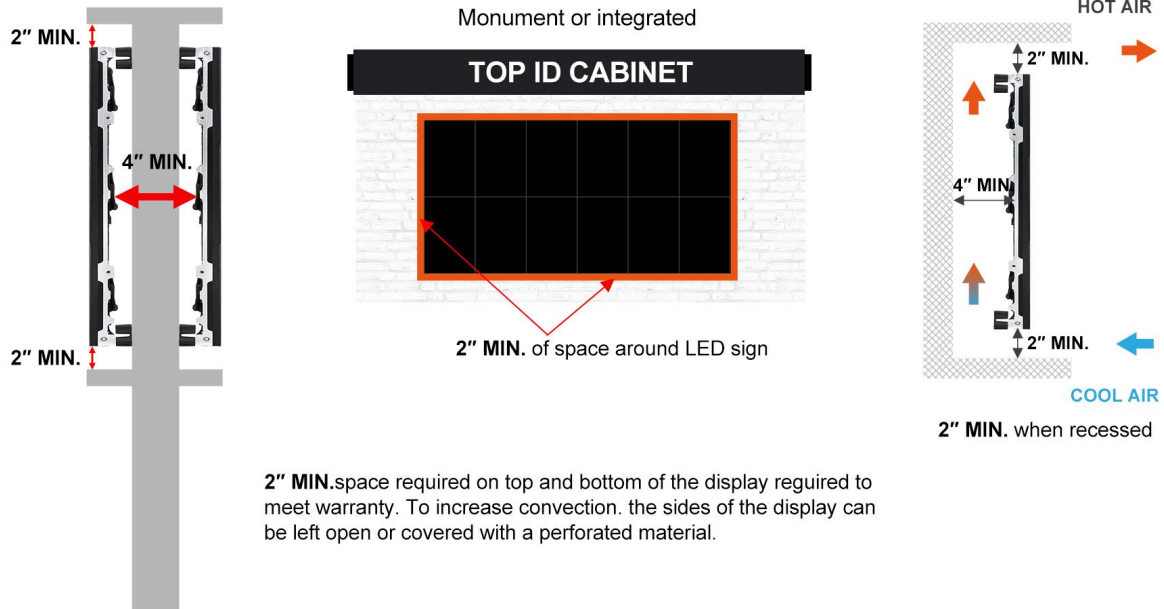

2" MIN. space required on top and bottom for convection
Do not block ventilation with cross brackets/ supports

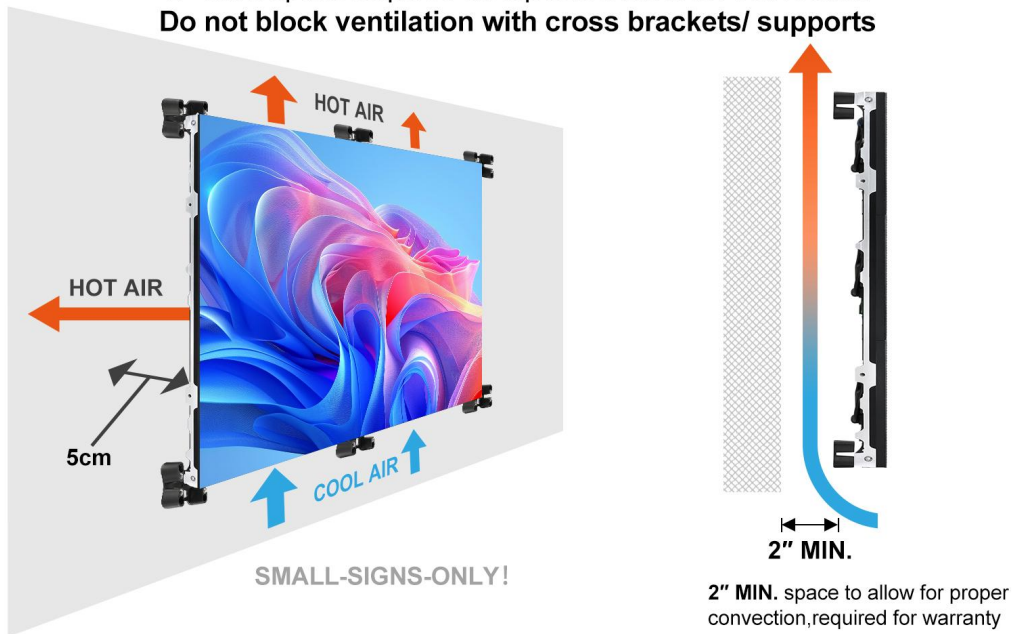

Specifications for P5 dual maintenance full color LED display



Module



Cabinet

- ◆ Integrated Module: with build-in control card、 power supply, each module is as a small cabinet. Don't need protection from cabinet like traditional way, which minimizes the faulty rate and enhances the stability.
- ◆ Simple support design: the module only needs simple frame to support and fix, saving a lot of installation costs.
- ◆ Flexible on screen dimension: The integrated module dimension is 640*320mm, the users can make it any size of screens.
- ◆ Light weight: Total weight of modules is 25.9KG/m².
- ◆ Low noise: without fans, the noise is <25dB.
- ◆ Quick setup: Use fast locks and connectors for fast installation, no screws needed.
- ◆ Front and rear access: customized sub-frame ensures fast service and installation.
- ◆ IP65 rating for front and rear.

Technical Parameters:

	Item	Specification Parameter
Module Parameter	Pixel Pitch、Resolution rate、size	5mm、128*64 Dots、640*320mm
	Pixel color、 Pixel LED	1R1G1B、 SMD1921
	Working voltage、 Module Power	DC4.2V、 105W
	Driving IC、 Driving way	MBI5124GP、 1/8
	HUB	QP640X320-HUB75(I6)-V1.0
Cabinet Parameter	Material、 Cabinet Weight(kg/Cabinet)	Cast aluminum frame 、 15.95Kg/PCS
	Resolution rate、 size、 Module quantity	128*192 Dots、 640*960*146mm、 1*3
	Density	40000 Dots/m ²
	White balance 、 Color temperature	5000 CD/m ² 、 6500-8000K
	view angel、 Non-Flatness、 Module interval	H: 110°; V: 110°、 <0.5mm、 <0.5mm
	Maximal power/m ² 、 Average power/m ²	≤520W/m ² 、 ≤170W/m ²
	Frame frequency、 Refresh frequency、 Gray grade	60Hz、 ≥1920Hz、 13bit
	Control system、 System supports	CHIPSHOW、 Windows XP, WIN 7
	Working temperature、 Protection grade	-20~50℃、 Front/Back: IP65
*Reference information, different configurations, different parameters		

Package Parameters:

Gross Weight (kg)	200kg (Estimated data, 10pcs /Case)
Outer Package Size	1030*1820*820mm (Estimated data, 10pcs /Case)
Packing Material	Carton + wooden pallet + pearl cotton



Assembly Sketch Map/Power Cable And Signal Cable Connection Sketch Map:

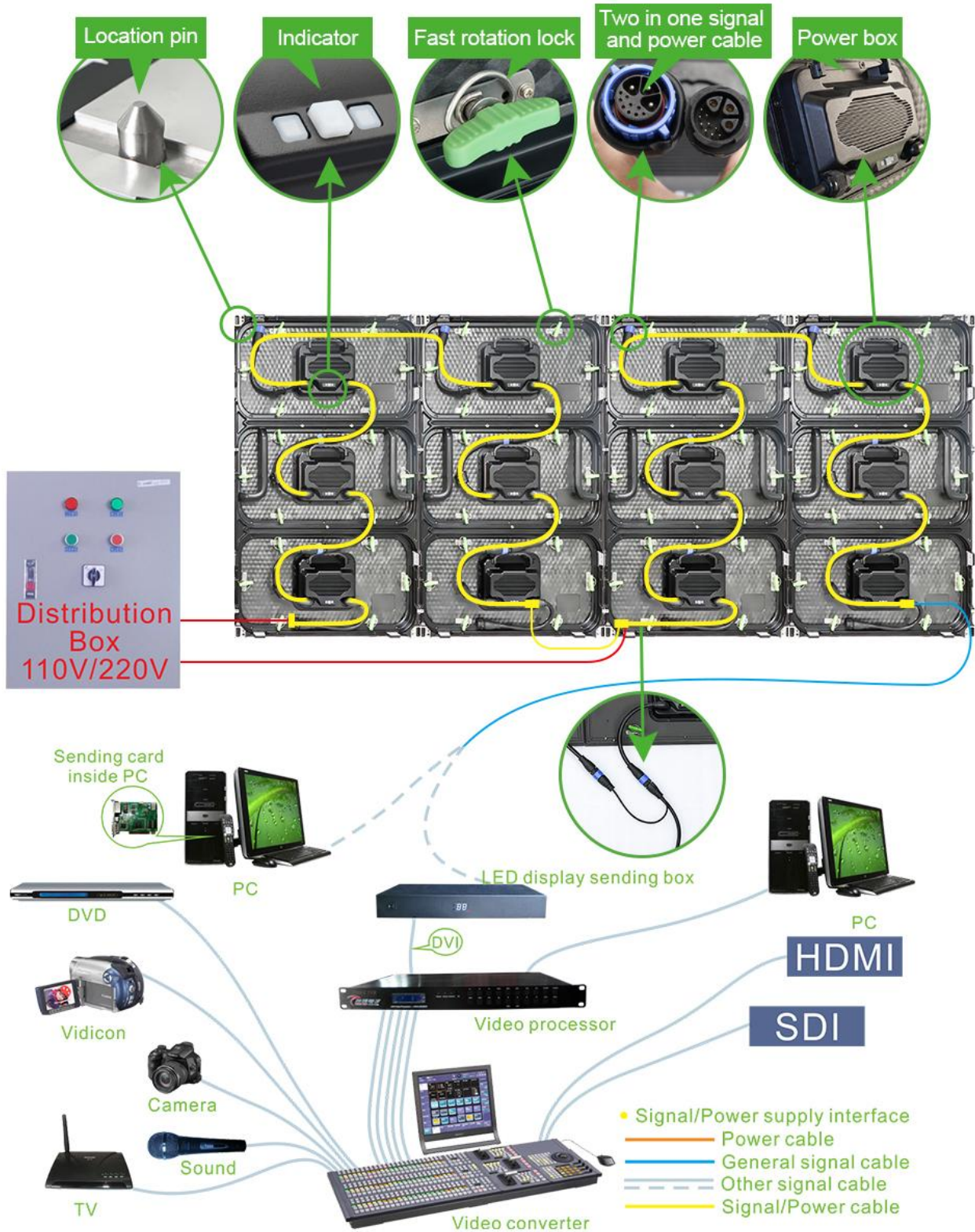

Static Cabinet integration SMALL-SIGNS-ONLY!

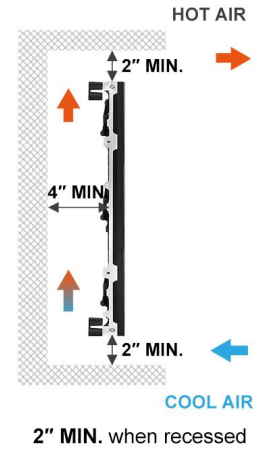
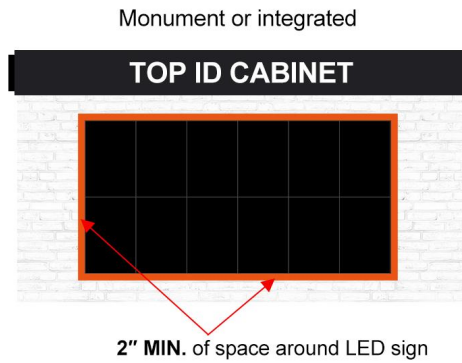
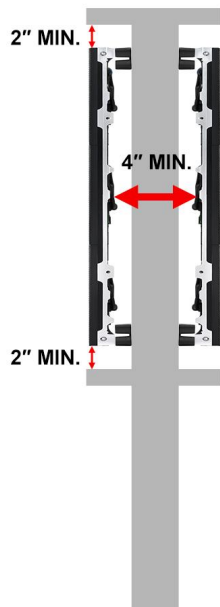

2" MIN. space required on top and bottom of the display required to meet warranty. To increase convection, the sides of the display can be left open or covered with a perforated material.

**2" MIN. space required on top and bottom for convection
Do not block ventilation with cross brackets/ supports**

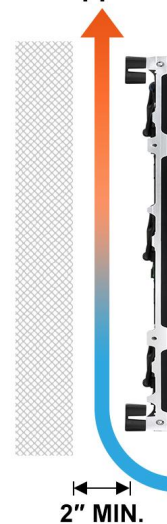
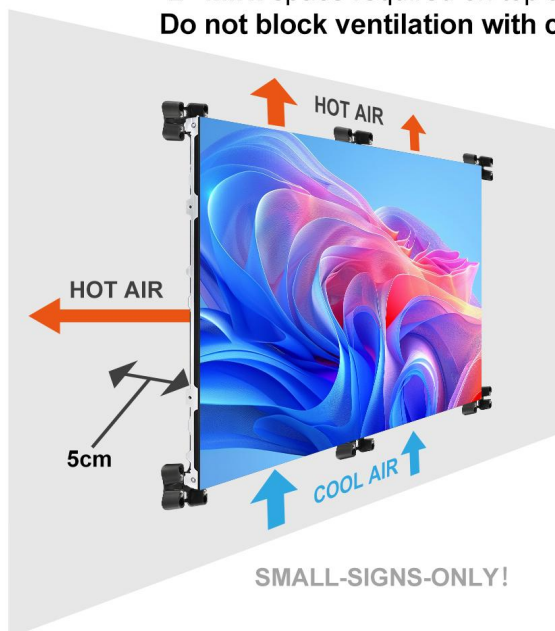

2" MIN. space to allow for proper convection, required for warranty

Specifications for P6.67 dual maintenance full color LED display

V:2022.07.11

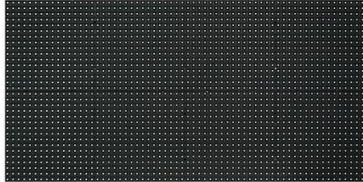

Module



Cabinet

- ◆ Integrated Module: with build-in control card、 power supply, each module is as a small cabinet. Don't need protection from cabinet like traditional way, which minimizes the faulty rate and enhances the stability.
- ◆ Simple support design: the module only needs simple frame to support and fix, saving a lot of installation costs.
- ◆ Flexible on screen dimension: The integrated module dimension is 640*320mm, the users can make it any size of screens.
- ◆ Light weight: Total weight of modules is 25KG/m².
- ◆ Low noise: without fans, the noise is <25dB.
- ◆ Quick setup: Use fast locks and connectors for fast installation, no screws needed.
- ◆ Front and rear access: customized sub-frame ensures fast service and installation.
- ◆ IP65 rating for front and rear.

Technical Parameters:

	Item	Specification Parameter
Module Parameter	Pixel Pitch、Resolution rate、size	6.67mm、96*48 Dots、640*320mm
	Pixel color、 Pixel LED	1R1G1B、 SMD2727
	Working voltage、 Module Power	DC4.2V、 125W
	Driving IC、 Driving way	ICN2069GP、 1/6
	HUB	P6.67 Signal HUB(AXS)-V1.2
Cabinet Parameter	Material、 Cabinet Weight(kg/Cabinet)	Cast aluminum frame、 16.5Kg/PCS
	Resolution rate、 size、 Module quantity	96*144Dots、 640*960*146mm、 1*3
	Density	22500 Dots/m ²
	White balance 、 Color temperature	5500 CD/m ² 、 6500-8000K
	view angel、 Non-Flatness、 Module interval	H: 120°; V: 120°、 <0.5mm、 <0.5mm
	Maximal power/m ² 、 Average power/m ²	≤650W/m ² 、 ≤210W/m ²
	Frame frequency、 Refresh frequency、 Gray grade	60Hz、 ≥1920Hz、 13bit
	Control system、 System supports	CHIPSHOW、 Windows XP, WIN 7
	Working temperature、 Protection grade	-20~50℃、 Front/Back: IP65
*Reference information, different configurations, different parameters		

Package Parameters:

Gross Weight (kg)	185kg (Estimated data, 10pcs /Case)
Outer Package Size	1030*1820*820mm (Estimated data, 10pcs /Case)
Packing Material	Carton + wooden pallet + pearl cotton



Assembly Sketch Map/Power Cable And Signal Cable Connection Sketch Map:

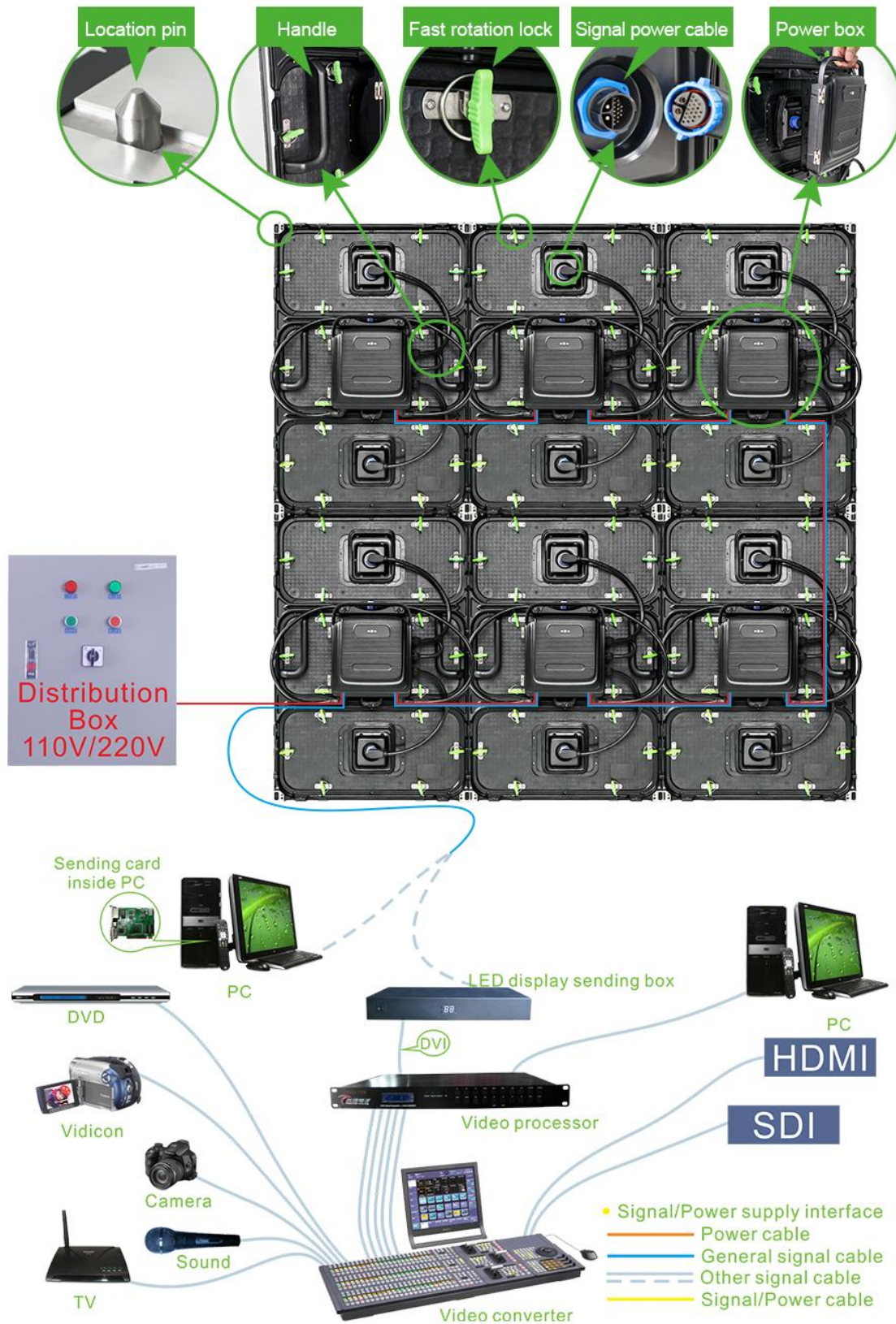

Static Cabinet integration SMALL-SIGNS-ONLY!

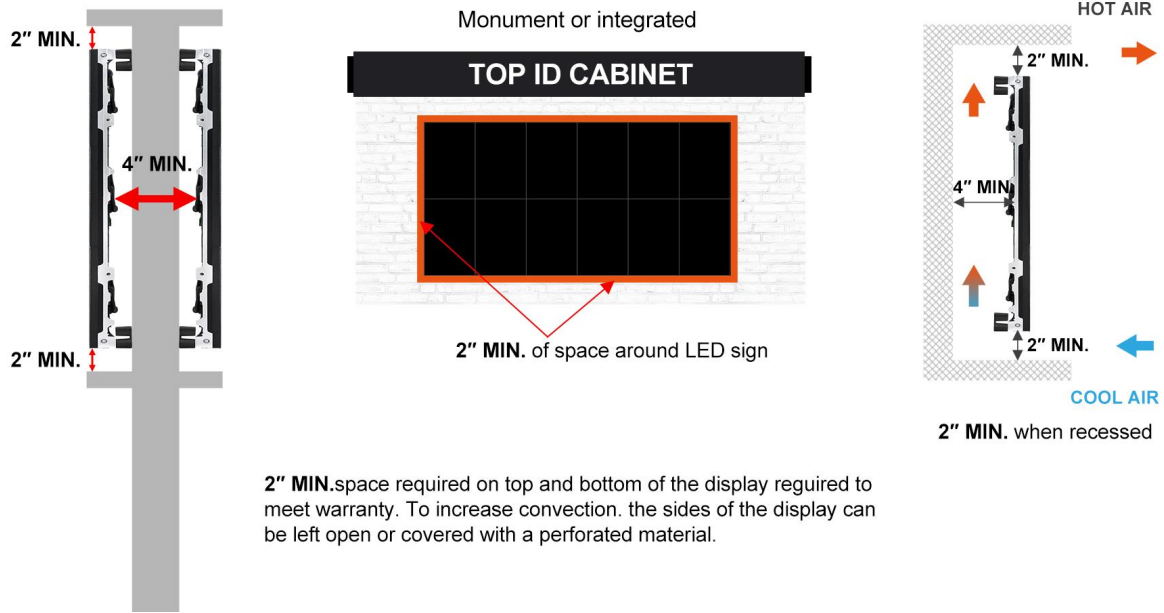

**2" MIN. space required on top and bottom for convection
Do not block ventilation with cross brackets/ supports**

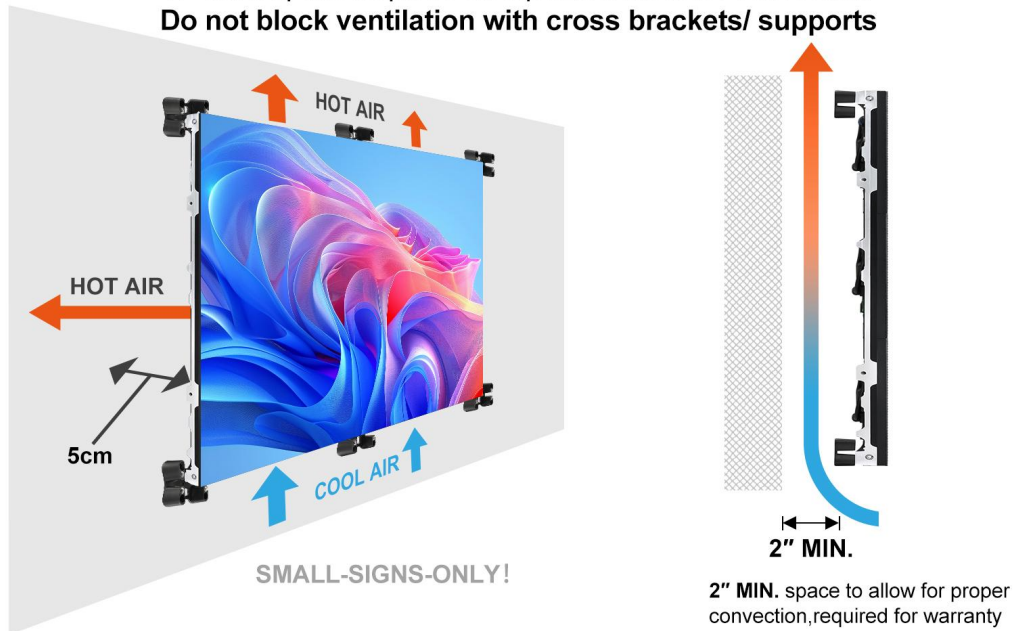

Specifications for P6.67 dual maintenance full color LED display

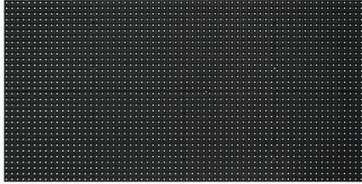

Module



Cabinet

- ◆ Integrated Module: with build-in control card、 power supply, each module is as a small cabinet. Don't need protection from cabinet like traditional way, which minimizes the faulty rate and enhances the stability.
- ◆ Simple support design: the module only needs simple frame to support and fix, saving a lot of installation costs.
- ◆ Flexible on screen dimension: The integrated module dimension is 640*320mm, the users can make it any size of screens.
- ◆ Light weight: Total weight of modules is 25.9KG/m².
- ◆ Low noise: without fans, the noise is <25dB.
- ◆ Quick setup: Use fast locks and connectors for fast installation, no screws needed.
- ◆ Front and rear access: customized sub-frame ensures fast service and installation.
- ◆ IP65 rating for front and rear.

Technical Parameters:

	Item	Specification Parameter
Module Parameter	Pixel Pitch、Resolution rate、size	6.67mm、96*48 Dots、640*320mm
	Pixel color、 Pixel LED	1R1G1B、 SMD2727
	Working voltage、 Module Power	DC4.2V、 125W
	Driving IC、 Driving way	ICN2069GP、 1/6
	HUB	P6.67 Signal HUB(AXS)-V1.2
Cabinet Parameter	Material、 Cabinet Weight(kg/Cabinet)	Cast aluminum frame、 15.95Kg/PCS
	Resolution rate、 size、 Module quantity	96*144Dots、 640*960*146mm、 1*3
	Density	22500 Dots/m ²
	White balance 、 Color temperature	5500 CD/m ² 、 6500-8000K
	view angel、 Non-Flatness、 Module interval	H: 120°; V: 120°、 <0.5mm、 <0.5mm
	Maximal power/m ² 、 Average power/m ²	≤650W/m ² 、 ≤210W/m ²
	Frame frequency、 Refresh frequency、 Gray grade	60Hz、 ≥1920Hz、 13bit
	Control system、 System supports	CHIPSHOW、 Windows XP, WIN 7
	Working temperature、 Protection grade	-20~50℃、 Front/Back: IP65
*Reference information, different configurations, different parameters		

Package Parameters:

Gross Weight (kg)	200kg (Estimated data, 10pcs /Case)
Outer Package Size	1030*1820*820mm (Estimated data, 10pcs /Case)
Packing Material	Carton + wooden pallet + pearl cotton



Assembly Sketch Map/Power Cable And Signal Cable Connection Sketch Map:

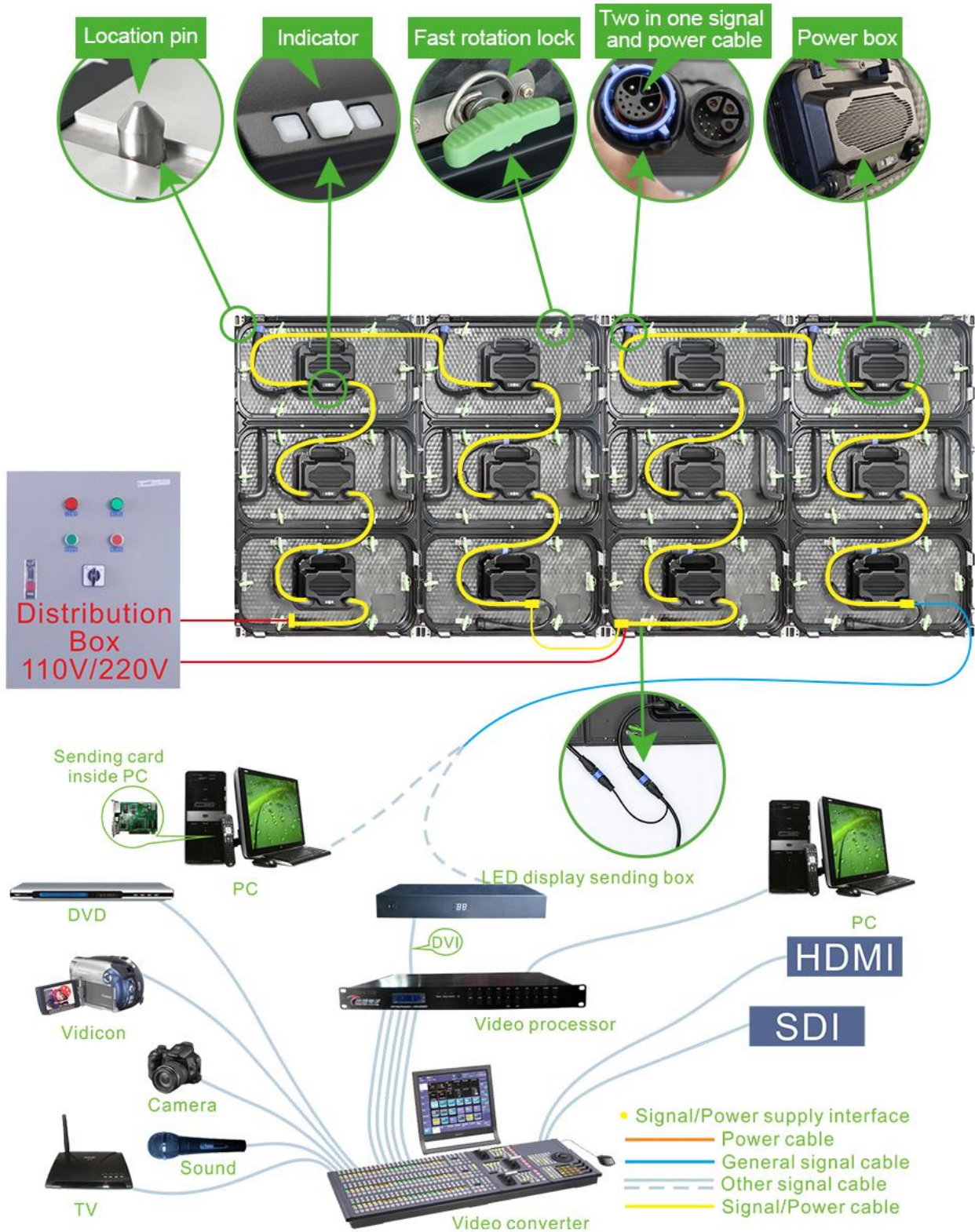

Static Cabinet integration SMALL-SIGNS-ONLY!

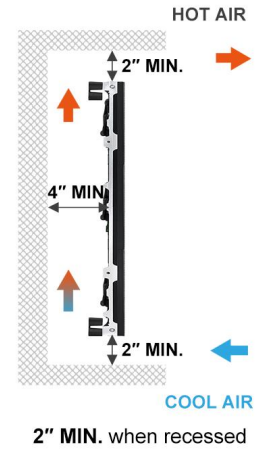
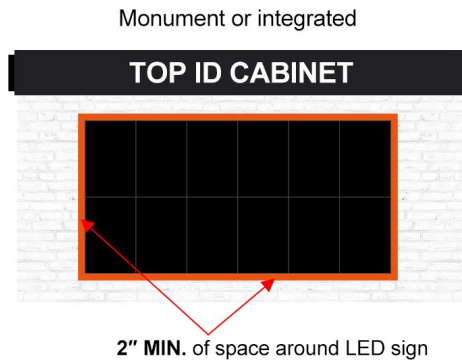
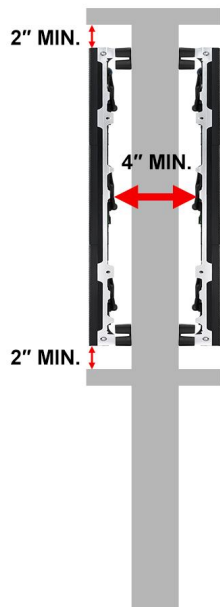

2" MIN. space required on top and bottom of the display required to meet warranty. To increase convection, the sides of the display can be left open or covered with a perforated material.

**2" MIN. space required on top and bottom for convection
Do not block ventilation with cross brackets/ supports**

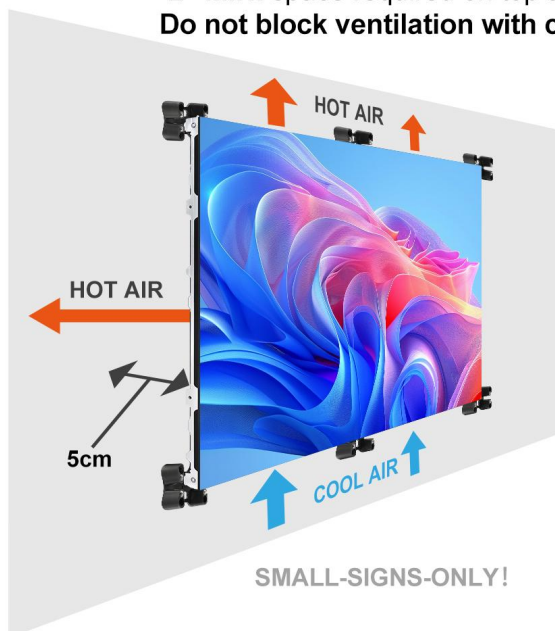

2" MIN. space to allow for proper convection, required for warranty